



REPORT

2017

LEITNER[®]
ropeways



LEITNER ropeways

Passion for high-tech

LEITNER[®]
ropeways

2017 was a year full of unique project highlights for LEITNER ropeways. With the company's constant innovation, these projects demonstrated the growing versatility of ropeways more than ever before. "Technology + Design = LEITNER ropeways" is the mobility expert's formula for success that created modern mobility experiences worldwide. Besides offering maximum user friendliness, these experiences made a clear statement: Sustainable and resource-saving transport is not a short-lived fad, it is our duty to coming generations. Beyond the tourism benefits, this aspect is increasingly important to cities around the world, which are focusing on reducing individual traffic and its negative effects. In total, the company built 32 systems in 12 countries.

LEITNER ropeways once again invested significantly in product improvements to achieve this output. The LeitControl control system is now considered as the industry benchmark, and offers customers a significant technological advantage when it comes to touch and command control. The centerpiece of many ropeways is the LEITNER DirectDrive, still setting standards today. LEITNER ropeways also raised the target again in looks and design. The cooperation with Italian design studio Pininfarina brought a new fresh approach, adding even more polish to top operating safety and functionality. The new station and the Symphony 10 premium cabin are the attractive examples of this unique cooperation.

Many prestigious reference projects show that LEITNER ropeways has its finger on the pulse with the new developments. LEITNER ropeways started 2018 with this impressive proof of its capabilities.



Livinalongo / IT



Kitzbühel / AT

RETROSPECTIVE

ITALY

Premiere for the next generation of ropeways

In Val Gardena, the two new 10-passenger gondola lifts, Piz Seteur I and Piz Seteur II, with a midway station and – a world's first – Symphony 10 premium cabins by Pininfarina provided a significant state-of-the-art upgrade. Another technical innovation is the increased time taken to pass through the station, now 65 seconds, which makes for stress-free boarding in six open cabins at the same time. In Alta Badia, the new 6-seater chairlift Biok increases the transport capacity significantly and represents a new “high” in our 71 year partnership and cooperation with the ski resort. The famous Sella Ronda ski circuit at the Pordoi Pass will be even more attractive from

now on: The new 10-passenger gondola lift Vauz-Pordoi increases the system's capacity to 3,200 passengers per hour. The new 6-seater chairlift Sonne in the Plan de Corones ski area also offers maximum comfort and a relaxed ascent. LEITNER ropeways upgraded the historic Funicolare Centrale in Naples to the state-of-the-art. Transporting 28,000 passengers daily along a 1,234 meter-long route, it is a particularly efficient ropeway. In Abruzzo, the Centro Turistico Gran Sasso commissioned LEITNER ropeways to build a 6-seater chairlift.

AUSTRIA

Pininfarina everywhere

The new 8-seater chairlift Jufen in Kitzbühel stands out with the striking station design by

Pininfarina. The ropeway transports 2,600 passengers per hour and is equipped with the power-saving LEITNER DirectDrive, LEITNER Premium Chair, seat heating and bubbles. In St. Johann/Tyrol, SkiStar invested in developing its ski resort, including in a 6-seater chairlift and a 10-passenger gondola lift by LEITNER ropeways. The Diamond EVO cabin in Pininfarina design was premiered in winter 2017/18 at Spieljoch in Zillertal valley. The system featuring LEITNER DirectDrive enhances comfort, speeds up journeys and increases transport capacity. The Reischlbergbahn and Ganzer X-press are two new 10-passenger gondola lifts that will really “speed things up” in the well-known ski resorts of Wildkogel Arena and Hochficht this winter. Obertauern is also relying on quality from LEITNER ropeways once again for the 8-seater chairlift Spitzbahn with elegant Premium Chair seats.

GERMANY, SWITZERLAND, FRANCE

Connecting, relieving, renewing

Berlin's first gondola lift, GD10 “Gardens of the World – Berlin”, was one of the absolute highlights of the International Garden Show (IGA Berlin 2017). The 10-passenger gondola lift transported visitors to the IGA site, and already carried three million passengers in the first six months. The ropeway will remain in place. In the Swiss SkiArena Andermatt-Sedrun, the new 6-seater chairlift Schneehüenerstock-Flyer from Vordere Felli up to Schneehüenerstock is an important connection between the two ski areas. The new 6-seater chairlift Ranfoilly Express in Les Gets, France, makes the ski resort a more relaxing place.



Hemavan / SE



Alanya / TR

SCANDINAVIA

Skiing with a view

The Swedish province of Lapland is not only home to skiing stars like Anja Pärson or Ingemar Stenmark, it also boasts the largest ski resort in Northern Sweden: Hemavan Tärnby. Against a breathtaking backdrop, LEITNER ropeways built the new Hemavan Gondol telemix system, which replaces a 2-seater chairlift. In Kvitfjell, the “Winter paradise of the north”, two new LEITNER ropeways systems were commissioned to expand the ski resort. A new reversible gondola ropeway with two Diamond EVO 8-passenger cabins in each direction connects the existing ski resort with a mountain on the opposite side. A new 6-seater chairlift also provides access to three new ski slopes with direct connections to 200 holiday homes.

POLAND, BOSNIA, TURKEY, CZECH REPUBLIC

From state-of-the-art ski resorts to new landmarks

Three new LEITNER ropeways systems were built in the Polish ski resort of Szczyrkowski: one GD10 gondola lift operated with LEITNER DirectDrive and two new 6-seater chairlifts with bubbles. LEITNER ropeways’ fourth project in Poland this year was to build a 4-seater chairlift, the CD4C Szczyrk – Jaworzyna in Szczyrk. Just 20 km from Sarajevo, in the Ravna Planina ski resort, the new 10-passenger gondola lift Jahorina Express points the way forward for a future connection to the former Olympic ski area Jahorina. The new 8-passenger gondola lift that runs from Turkish seaside resort Alanya to Alanya Castle

that overlooks it offers an impressive view. In northeastern Turkey, roughly 50 km from the Georgian border, a new 4-seater chairlift adds to the skiing fun in the little ski resort of Ardahan. In the Czech ski resort of Koprivná, a 6-seater chairlift replaces an existing LEITNER ropeways system.

SPAIN, MEXICO

Suspended tourist attraction

LEITNER ropeways modernized the historic funicular railway Funicular de Montjuïc in Barcelona. The two carriages were given a complete overhaul, the electrical and mechanical components and the ropes were replaced, and the brakes and emergency brakes were also modernized. The funicular, used by 1.5 million

passengers each year, was also equipped with the modern LeitControl control system and an audio & video system for the vehicles and stations. LEITNER ropeways also built a tourist ropeway in Mexico. In Torreón, Northern Mexico, the 8-passenger gondola lift Cristo de las Noas carries tourists to the statue of Christ at the summit of Mount Noa, visited by many thousands of pilgrims every year. The journey to the monumental statue takes five minutes, and the view through the panoramic windows makes it a real experience.



OUTLOOK

For LEITNER ropeways, 2018 will once again be all about boosting the attractiveness of more ski resorts. With the expanded product range and the popular innovations designed by Pininfarina, LEITNER ropeways offers a technically and visually unique overall package. The many exclusive services available to customers in every situation contribute to this. Among other things, these services include the spare parts range with genuine products in guaranteed quality for all standard systems, advice from experienced technical experts and convenient one stop shopping. LEITNER ropeways aims to continue to position itself as a premium and experienced partner that focuses on its traditional strengths, available at all times, thanks to its innovation spirit.

WINTER SPORTS

In 2018, the company is once again implementing multiple major winter sports projects. One installation in Switzerland is leading the way: LEITNER ropeways is building the world's highest 3S system on the Klein Matterhorn, for Zermatt Bergbahnen, with construction due for completion in fall 2018. In Germany, two new chairlifts will start operation at Mount Jenner. A 10-passenger gondola lift will also boost capacities and increase comfort for Jennerbahnen in Berchtesgaden. In Voss, Norway, construction work is starting on the new 3S gondola lift to Hanguren mountain. The system is to open in summer 2019 and will be equipped with 13 modern Symphony cabins.

TOURISM AND URBAN MOBILITY

Starting April 2018, a new 10-passenger gondola lift by LEITNER ropeways will transport tourists and local residents directly from the center of Sarajevo to the summit of Trebević. This will revitalize the city's landmark, which was destroyed in the Bosnian War. In Dharamsala, Northern India, known as the home of the Dalai Lama, LEITNER ropeways is building a spectacular 8-passenger gondola lift. The popular tourism destination of Upper Dharamsala is roughly 3,000 meters above the city at the foot of the Himalaya mountains. The new ropeway will help restrict the heavy road traffic along the tricky mountain road and make the trip to the top station – just 300 meters from the Dalai Lama's residence – quick and convenient. In Korea, the 2S ropeway

in Sacheon will connect a small island in the marine canal with the summit of the mountain via a midway station. LEITNER ropeways is renovating another urban ropeway project in Barcelona. The Funicular de Tibitabo provides access to a popular amusement park and will open again in 2020. In Trabzon, Turkey, a state-of-the-art aerial tramway will soon run directly from the Black Sea to a new hotel resort and recreation area. A new inclined ropeway will be built in the southwestern Finnish city of Turku in 2018. The IE30 Turku starts in the historic center of the oldest city in Finland and runs to the residential area of Kakolanmäki, which overlooks the city. LEITNER ropeways is consolidating its market leadership in the air cushion technology sector by completely overhauling the Dorfbahn Serfaus. The works on the new funicular railway are to be completed by 2019.

Examples of
365 working days ...





GD10 PIZ SETEUR I+II

Wolkenstein - Selva Val Gardena / IT

Piz Seteur I

Inclined length	970 m
Vertical rise	209 m
Transport capacity	3.600 p/h
Power	794 kW
Total number of vehicles	50
Total number of towers	8

Piz Seteur II

Inclined length	486 m
Vertical rise	104 m
Transport capacity	3.600 p/h
Power	353 kW
Total number of vehicles	30
Total number of towers	6

At the foot of the Sassolungo, LEITNER ropeways built one of the major highlights of the 2017/2018 winter season: the new Piz Seteur gondola lift consists of two sections and sets new standards in comfort, safety and performance. The Symphony 10 cabin, premiered in Val Gardena, offers far more space and a larger entrance area for passengers. The unmistakable Pininfarina design rounds off the package. The extended board-

ing time in the station (65 seconds), with six opened cabins, give winter sports enthusiasts more time for safe and stress-free embarking and disembarking. The new intermediate station was also designed by Pininfarina, and offers great benefits thanks to a perfect combination of state-of-the-art Pininfarina design and sophisticated construction. Of course, it also increases passenger comfort.

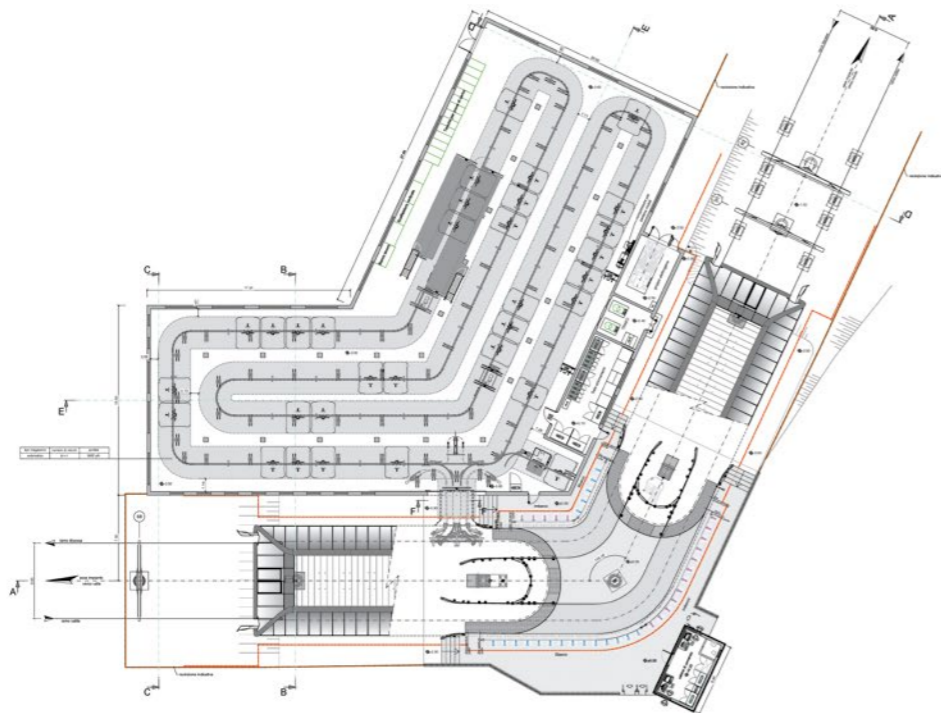







GD10 SPIELJOCHBAHN I+II

Fügen - Zillertal / AT

Inclined length	3887 m	Power	1660 kW
Vertical rise	1212 m	Total number of vehicles	132
Transport capacity	3000 p/h	Total number of towers	27

In 2017, LEITNER ropeways launched an upgraded version of the Diamond cabin: The Diamond EVO is the symbiosis of the successful Symphony and Diamond models, which mark the dawn of a new age with their construction, finishing and look. The Diamond EVO cabin – EVO is short for Evolution – was premiered this winter with the opening of the Spieljochbahn. The new cabin builds on the familiar Diamond model and is available either with sliding doors and fixed components along

the side face, or with full-size sliding doors along the side face. The new main frame and outer profile are based on the Pininfarina design of the Symphony cabin. Features of the new Diamond EVO include the slimmer support structures and the option of equipping the exterior lighting with LED strips integrated in the support profiles. The Diamond EVO cabin's modular design offers an impressive array of customization options.

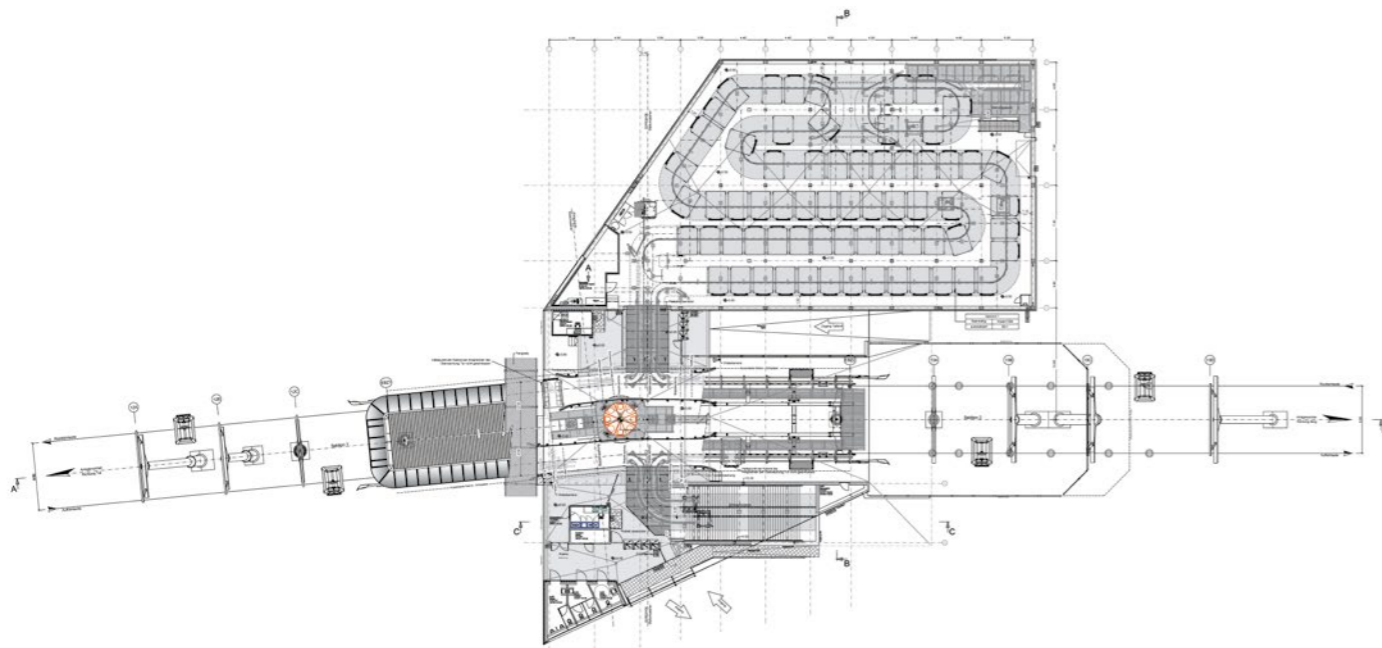

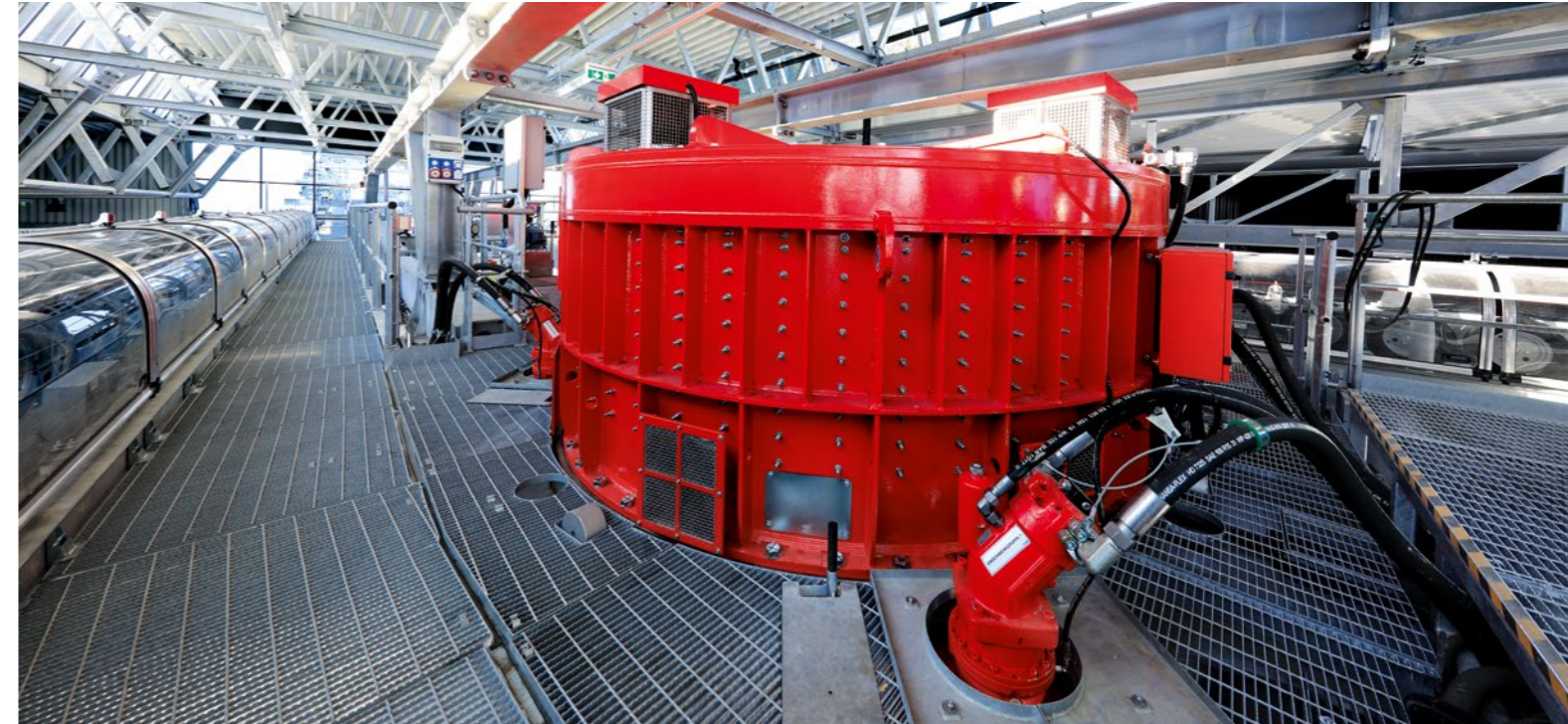





GD10 EICHENHOF I

St. Johann in Tirol / AT

Inclined length	904 m	Power	294 kW
Vertical rise	140 m	Total number of vehicles	24
Transport capacity	1880 p/h	Total number of towers	8

The Eichenhof 10-passenger gondola lift modernizes and upgrades Eichenhof in St. Johann in Tirol. Above all, it makes it simple and particularly comfortable for children, beginners and ski schools to access the ski resort. Its location near the car park also makes it ideal

for pedestrians to reach the “Granderschupf” hut using the most barrier-free means of transport possible. The 24 cabins travel 904 meters to that point, transporting 1,880 passengers per hour.

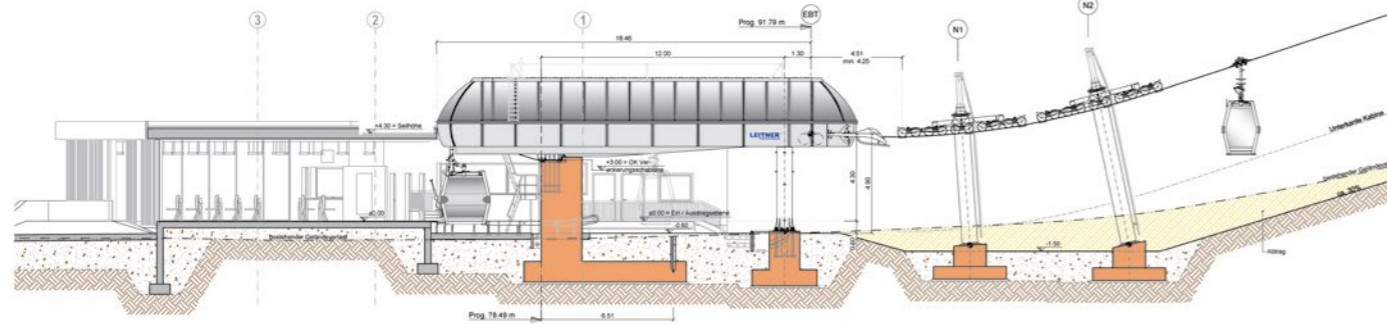





GD10 GANZER X-PRESS

Neukirchen am Großvenediger / AT

Inclined length	1509 m	Power	529 kW
Vertical rise	402 m	Total number of vehicles	50
Transport capacity	2840 p/h	Total number of towers	10

LEITNER ropeways and the Salzburg ski resort Wildkogel-Arena already have a long tradition of working together. For example, the Pfeifferköpfbahn chairlift was the first in Austria to be equipped with the LEITNER control system. The Ganzer X-press 10-passenger gon-

dola lift adds substantial capacity in the heart of the ski resort. That is particularly important as the ski lessons are held there. As a result, the project with a transport capacity of 2,840 passengers per hour will put an end to the waiting times guests previously had to endure.

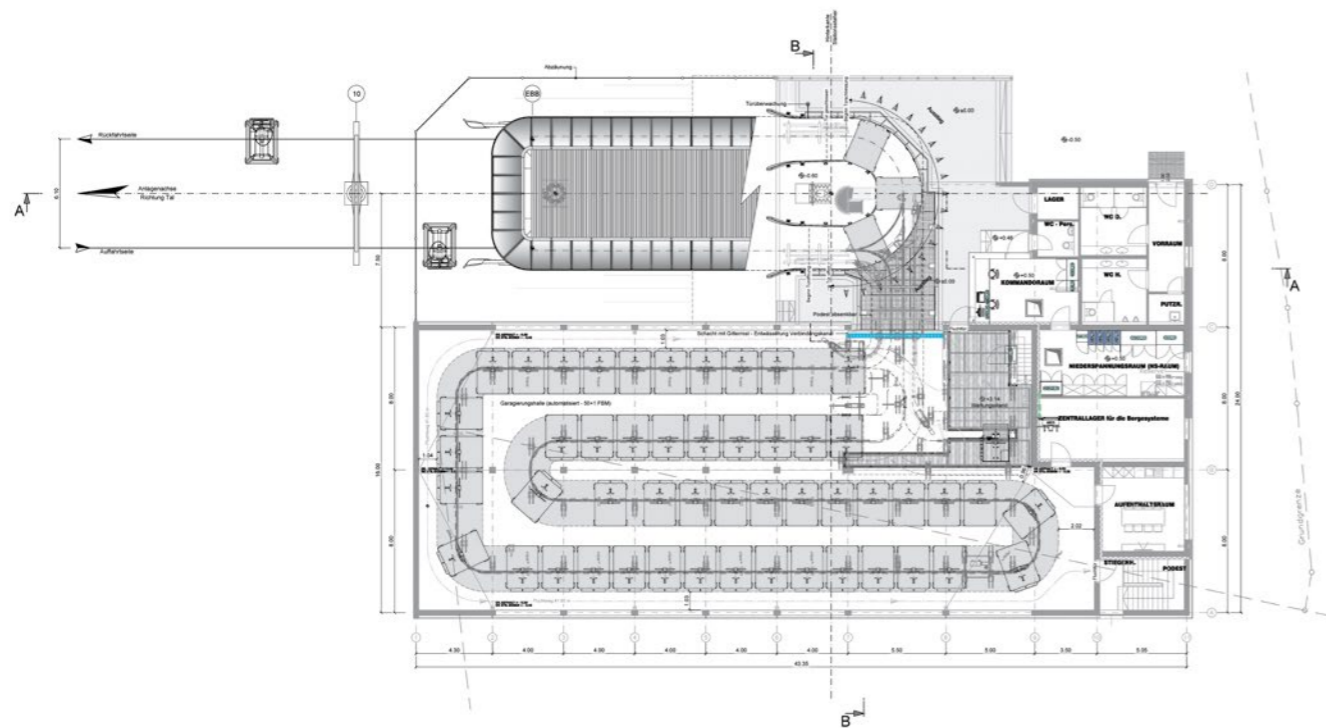





GD10 REISCHLBERG-BAHN I+II

Hochficht / AT

Inclined length	1420 m	Power	926 kW
Vertical rise	344 m	Total number of vehicles	56
Transport capacity	2800 p/h	Total number of towers	14

The Reischlbergbahn has been in operation in the Hochficht ski area in Upper Austria, in the border triangle of Austria, Germany and Czechia since the 2017/18 winter season. The ropeway construction project also resulted in many changes with a positive operative impact. In particular, the children taking part in ski lessons will benefit from the new intermediate station at the "Überlebenshütte",

which also houses a roofed magic carpet and the Kinderland kids park. From there, the two ropeway sections will be driven by a double-grooved drive sheave, with the two rope loops tensioned separately in the bottom and top stations. The Reischlbergbahn links two parts of the ski area, serving as an important connection. Overall, the ropeway replaces three surface lifts and a T-bar lift.

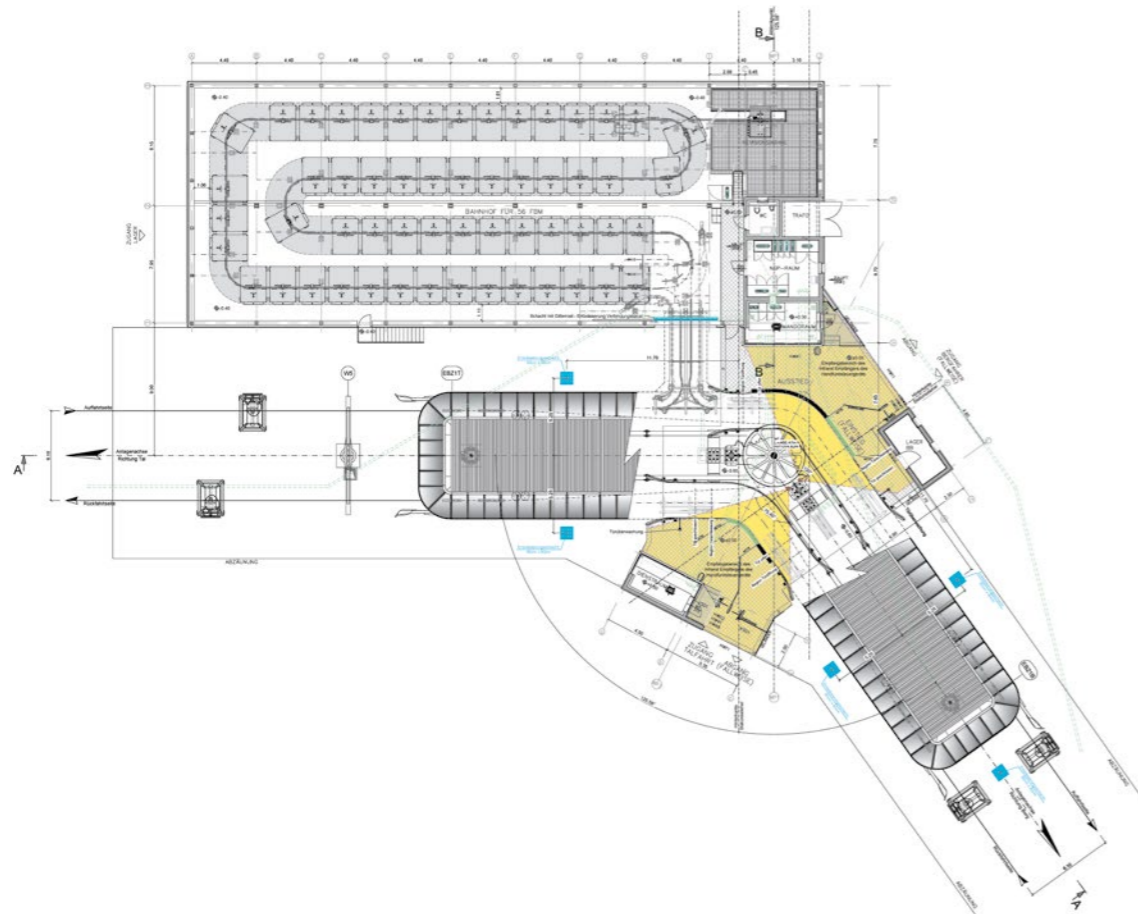

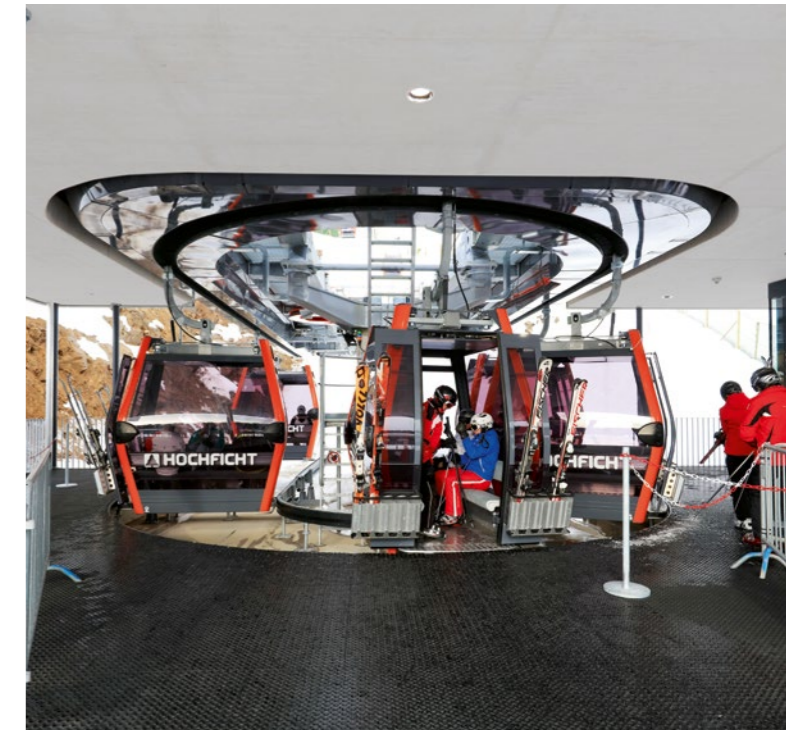



GD10 VAUZ-PORDOI

Livinallongo del Col di Lana / IT

Inclined length	2265 m	Power	882 kW
Vertical rise	379 m	Total number of vehicles	81
Transport capacity	3.200 p/h	Total number of towers	14

The gondola lift at Passo Pordoi replaces a 4-seater chairlift from 1998, resulting in a clear capacity boost. The Diamond XLine cabins offer passengers plenty of space and allow them to keep their skis with them in the

cabin. In the bottom station, the vehicles can be slowed down significantly for more comfortable boarding, as the station length has been extended. The ropeway is equipped with LEITNER DirectDrive.

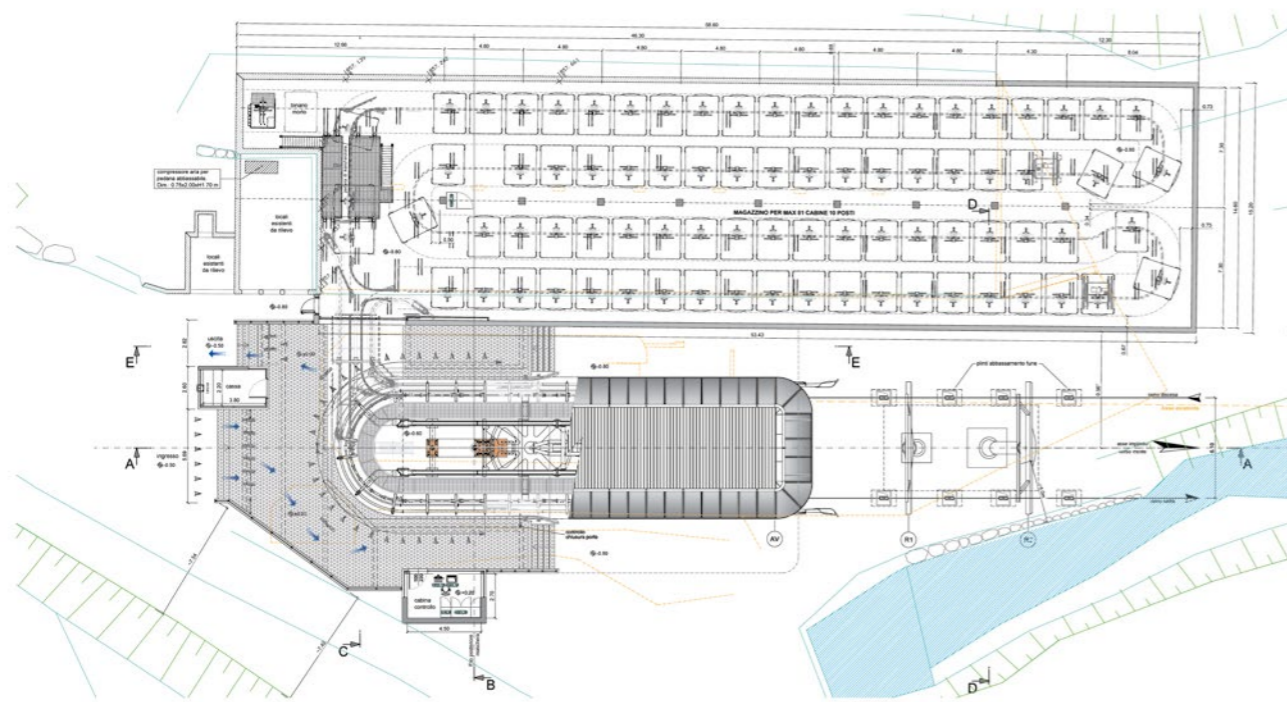





GD10 PALE

Pale / BA

Inclined length	1233 m	Power	360 kW
Vertical rise	361 m	Total number of vehicles	23
Transport capacity	1600 p/h	Total number of towers	7

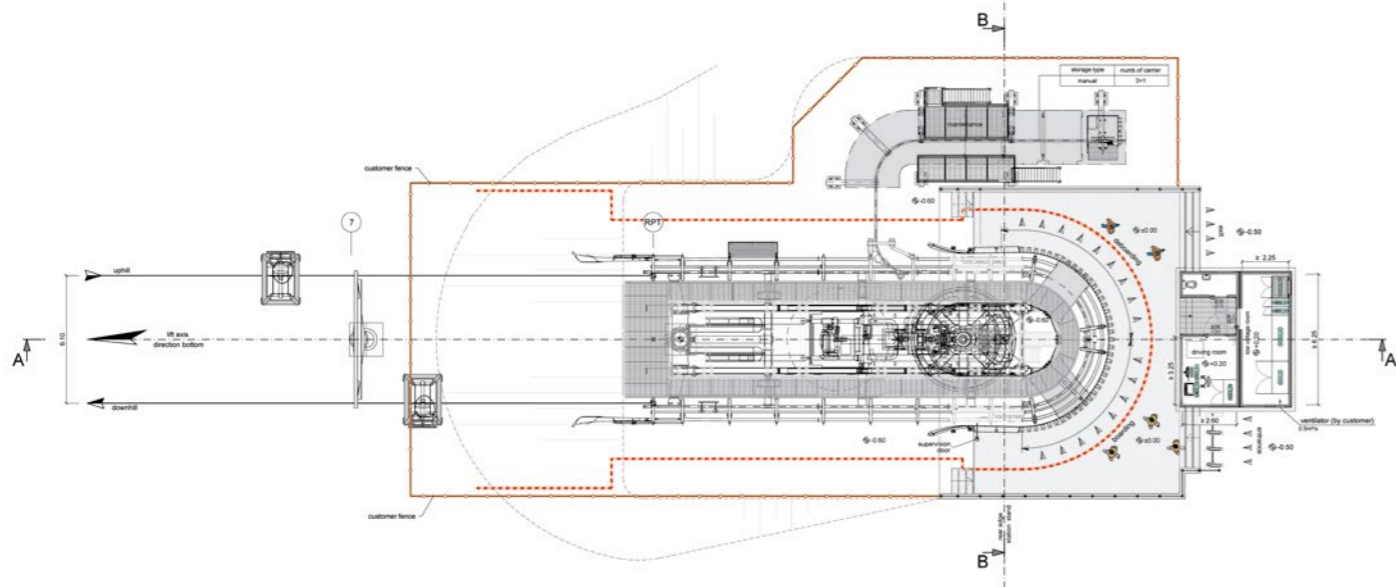



GD10 PARKOVISKO HALA SKRYCZEŃSKA

Szczyrk / PL

Inclined length	1488 m	Power	794 kW
Vertical rise	410 m	Total number of vehicles	51
Transport capacity	3000 p/h	Total number of towers	10

The Szczyrk ski resort is not only one of the largest, but also one of the most popular resorts in winter-sports crazy Poland. In collaboration with LEITNER ropeways, the operators are initiating a comprehensive modernization project with the construction of three new ropeways. The GD10 gondola lift “Parkovisko –

Hala Skrzyczeńska”, powered by LEITNER DirectDrive, currently the largest ropeway project in Poland, serves as an additional connecting ropeway from the center of the village, enhancing comfort and boosting the transport capacity. LEITNER ropeways has also built two 6-seater chairlifts in the ski resort.

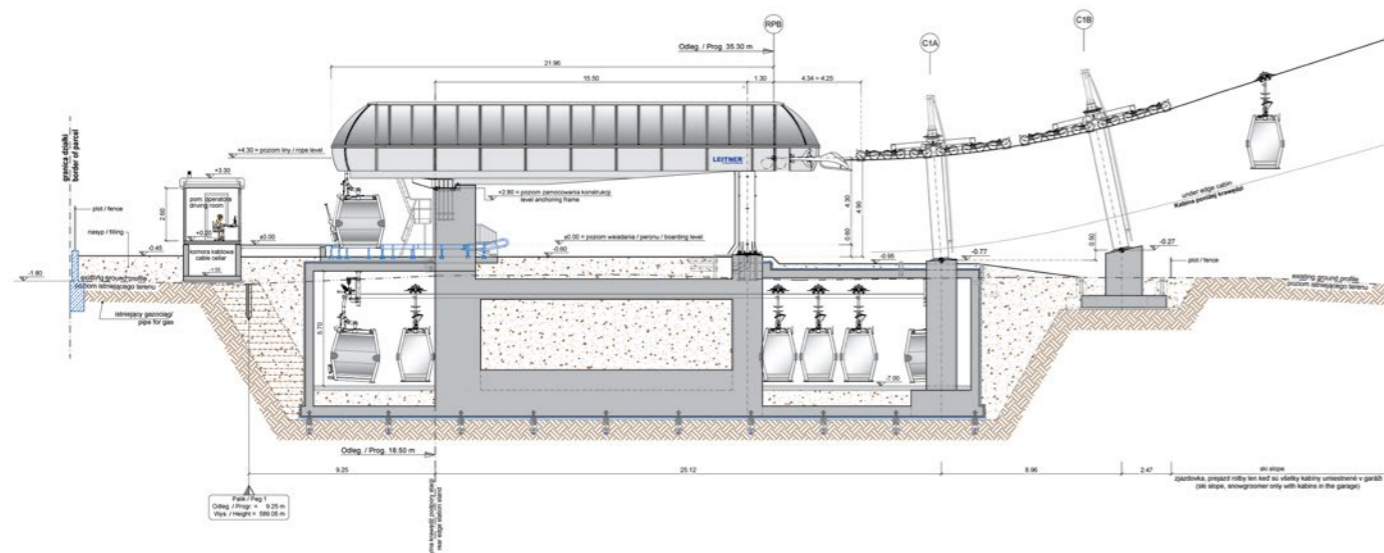





GD10 SEILBAHN GÄRTEN DER WELT

Berlin / DE

Inclined length	1573 m	Power	482 kW
Vertical rise	85 m	Total number of vehicles	64
Transport capacity	3000 p/h	Total number of towers	13

The "Gardens of the World – Berlin" ropeway was one of the absolute highlights of the International Garden Show (IGA Berlin 2017). And not just for IGA visitors – the citizens of Berlin were also enthusiastic from day one. The impressive result: The ropeway carried three million passengers in the first six months. It created a new attraction for the German

metropolis, which soon became a popular leisure tip for citizens looking for a recreational activity. The ropeway will remain a top spot in the nation's capital in the future. Since 1st of December 2017, it offers another attractive way to escape the hustle and bustle of the city for a few hours and enjoy environmentally friendly mobility surrounded by nature.

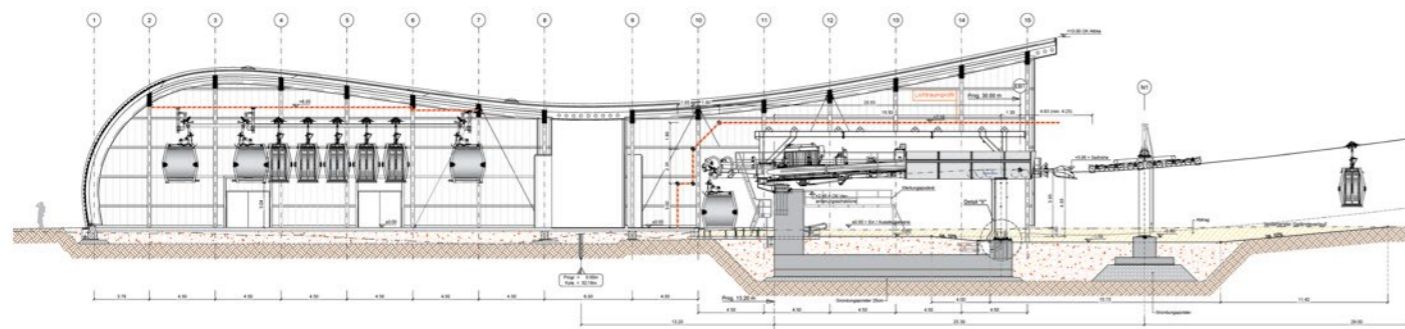





GD8 TORREÓN

Torreón / MX

Inclined length	1467 m	Power	200 kW
Vertical rise	138 m	Total number of vehicles	18
Transport capacity	750 p/h	Total number of towers	6

High above the city of Torreón in Northern Mexico, the radiant white figure of Christ welcomes pilgrims and tourists with open arms. Each year, thousands of people come to this place of pilgrimage in the state of Coahuila. Until now, many visitors have gone up the de las Noas hill on foot to see the famous landmark, the church and the panorama restaurant. Since 2017, they can take a comfortable

gondola lift directly from the historic center of the desert city to the 22 meter statue and enjoy the fabulous view there. The municipal administration of Torreón, at the edge of the Chihuahua desert also had a park and mountain bike route built, in addition to the ropeway, to make the area even more attractive to tourists.

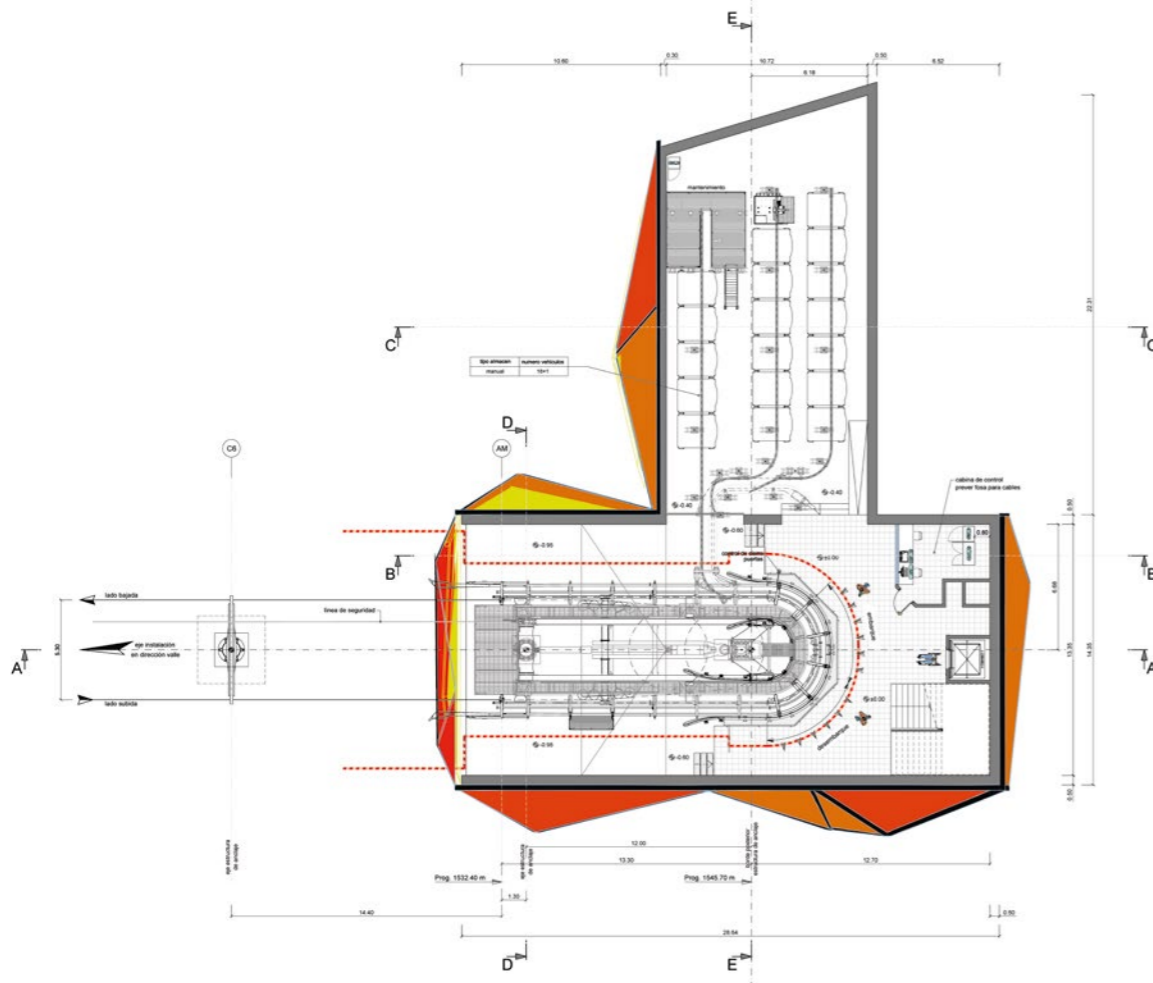





GD8 ALANYA

Alanya / TR

Inclined length	847 m	Power	162 kW
Vertical rise	161 m	Total number of vehicles	17
Transport capacity	1156 p/h	Total number of towers	5

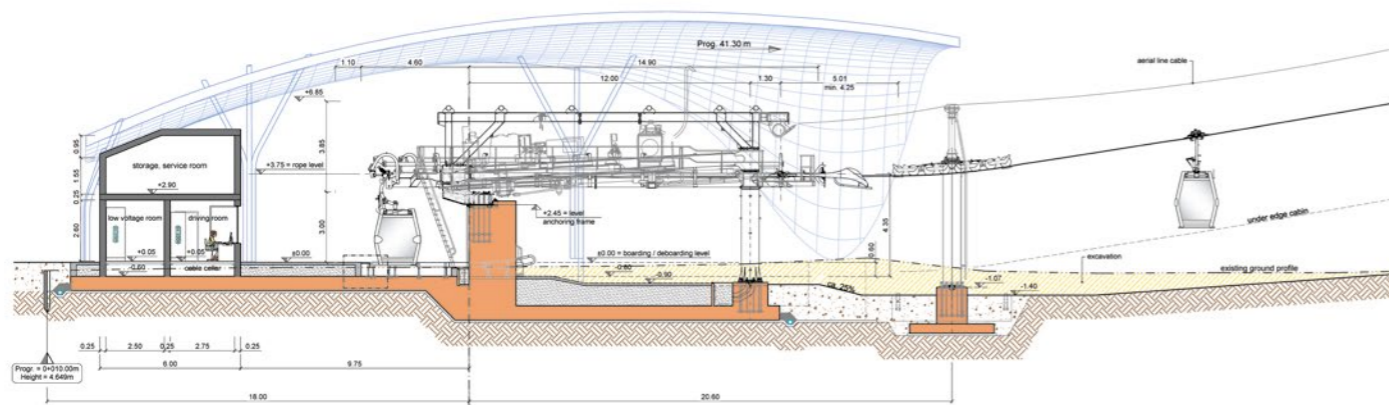

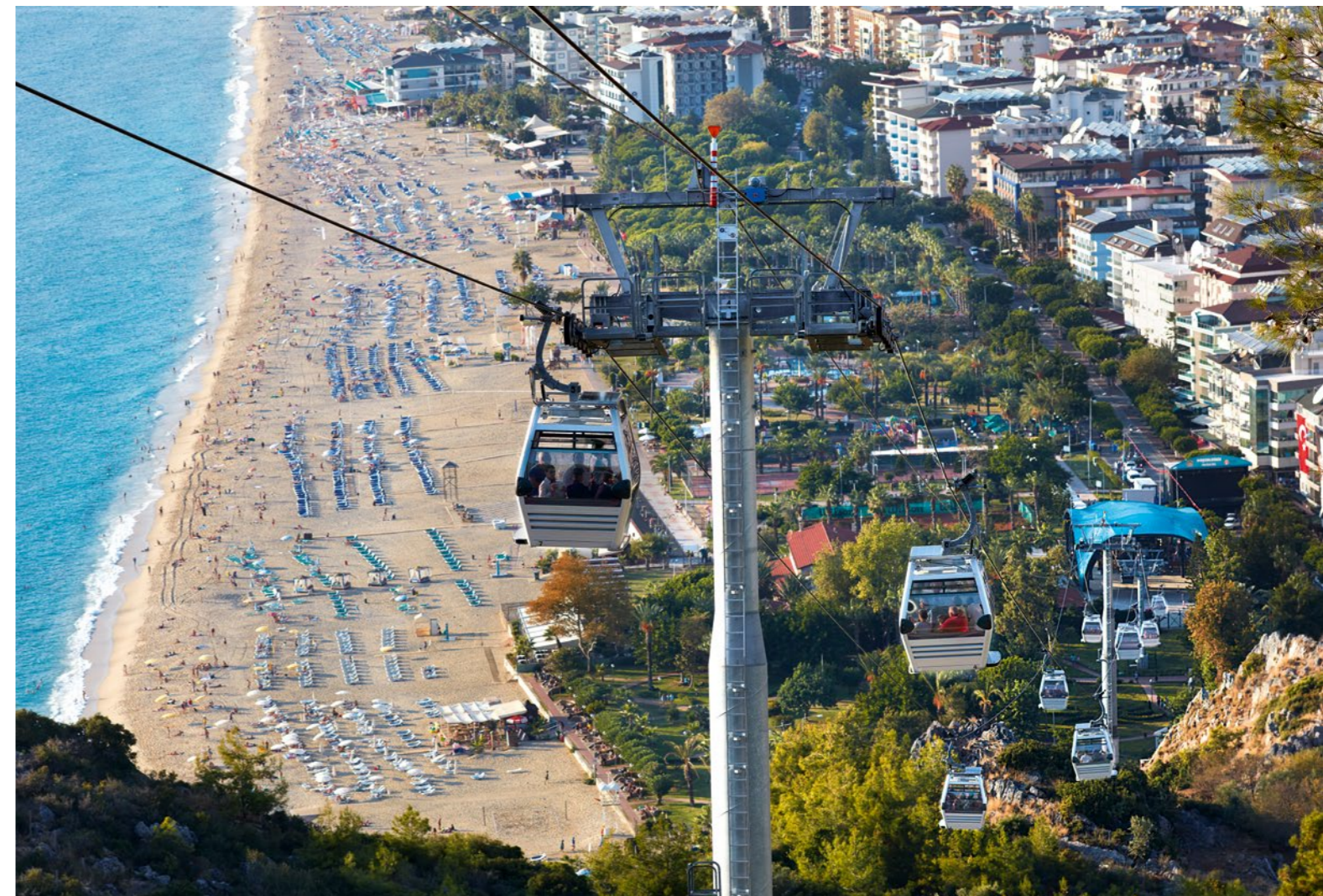



GFR KVITFJELL

Kvitfjell / NO

Inclined length	253 m	Power	100 kW
Vertical rise	2 m	Total number of vehicles	4
Transport capacity	500 p/h	Total number of towers	3

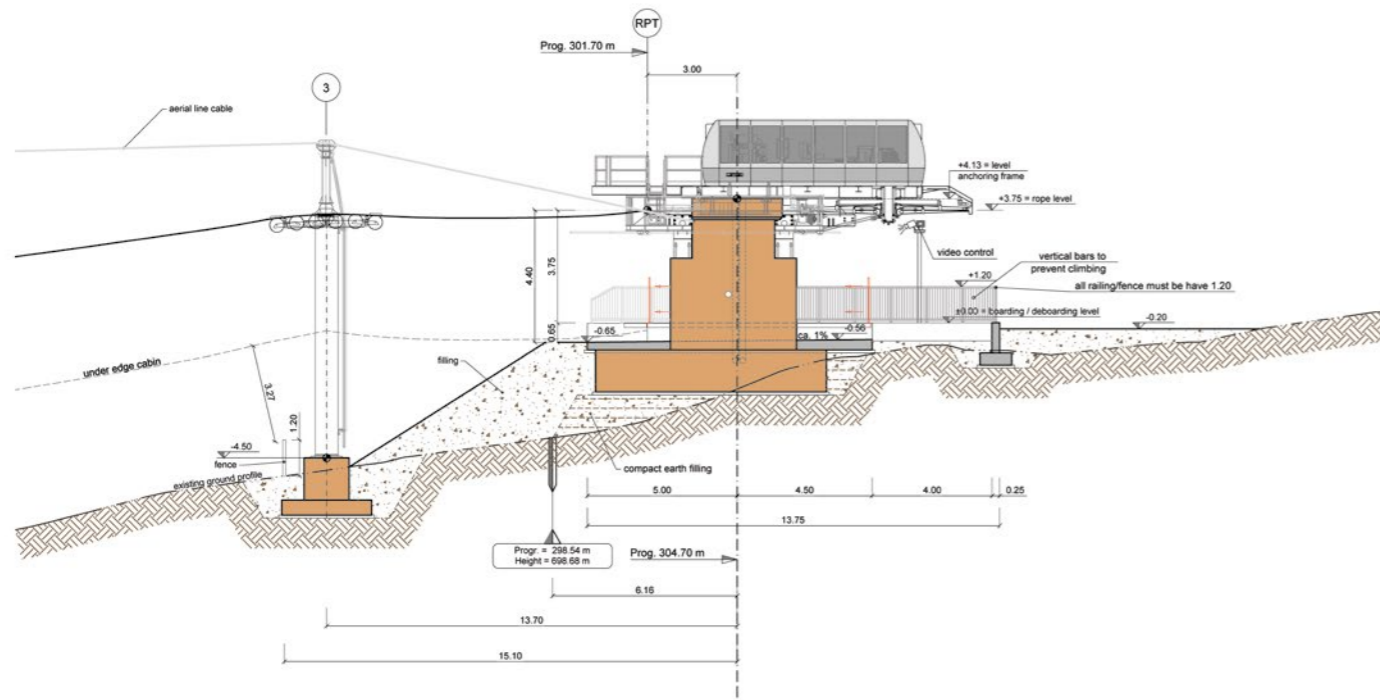



TMX6/8 HEMAVAN GONDOL

Hemavan / SE

Inclined length	1447 m	Power	441 kW
Vertical rise	335 m	Total number of vehicles	68
Transport capacity	2570 p/h	Total number of towers	16

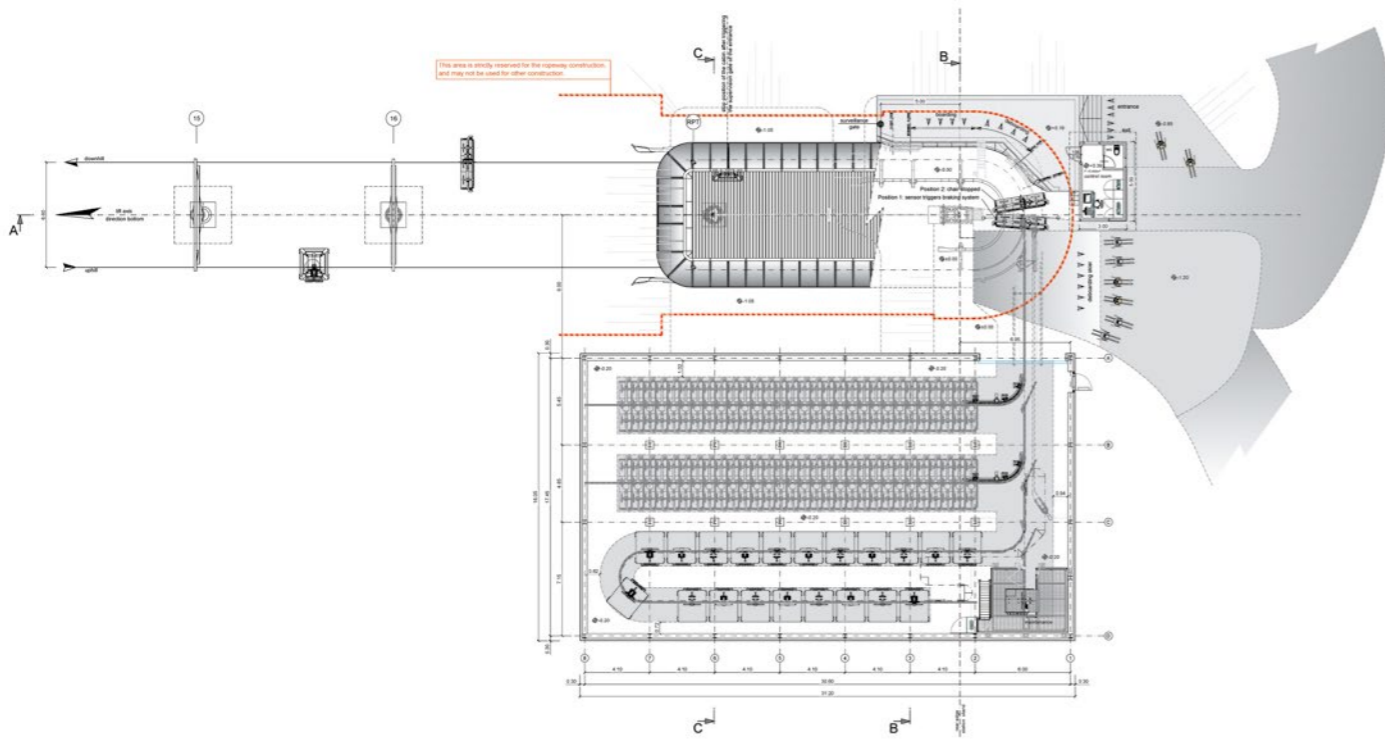





CD8C JUFEN

Kitzbühel / AT

Inclined length	882 m	Power	489 kW
Vertical rise	300 m	Total number of vehicles	32
Transport capacity	2600 p/h	Total number of towers	11

The long-standing cooperation between Bergbahn AG Kitzbühel and LEITNER ropeways reached a new high in the 2017/18 winter season. With the new 8-seater chairlift Jufen, the operators are relying on latest generation ropeway technology in the traditional Tyrolean winter sports destination. Besides the outstanding comfort and a significantly higher

transport capacity, the new look is proving a real eye-catcher: the Pininfarina-designed stations are a new highlight in the home of the world's most famous downhill race. Besides an attractive design, the station designed by Pininfarina also brings a series of technological innovations to the ski area.

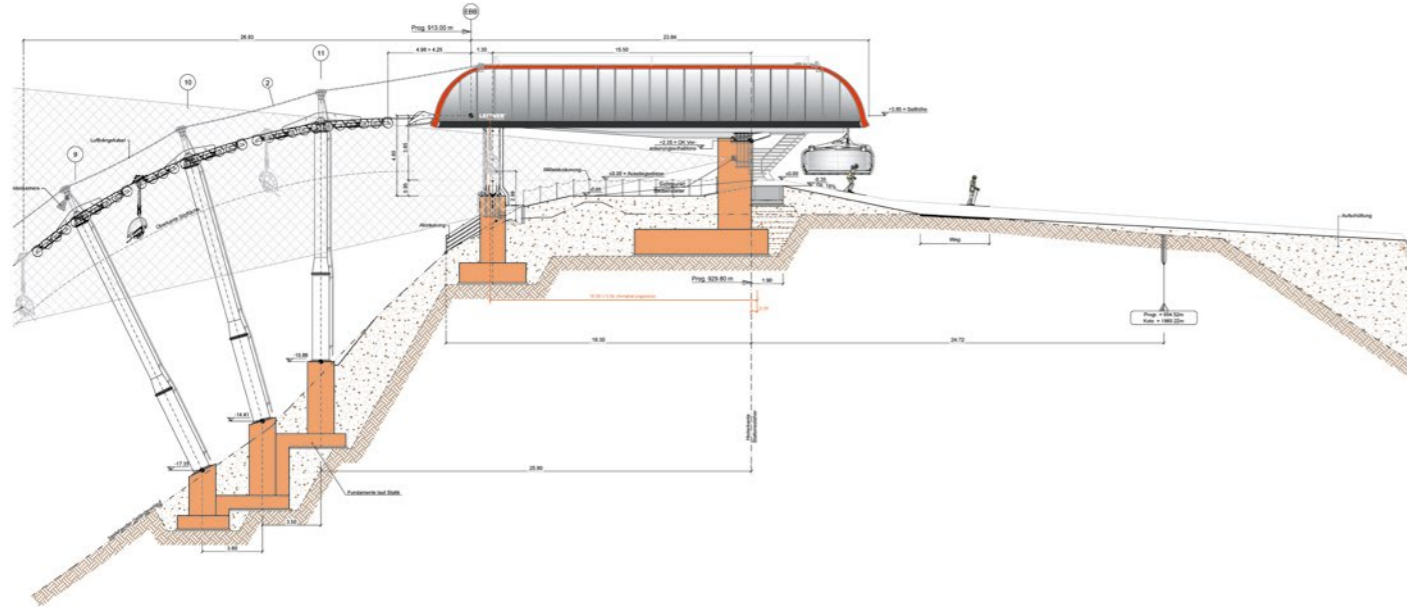





CD8C SPITZBAHN

Obertauern / AT

Inclined length	1482 m	Power	794 kW
Vertical rise	397 m	Total number of vehicles	48
Transport capacity	2585 p/h	Total number of towers	17

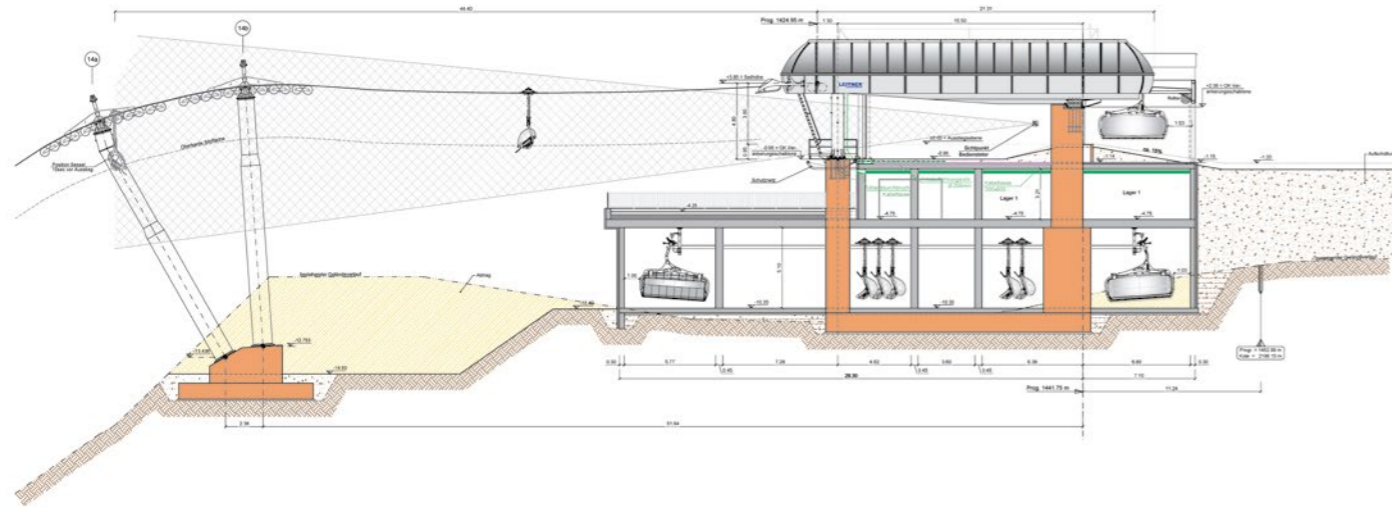

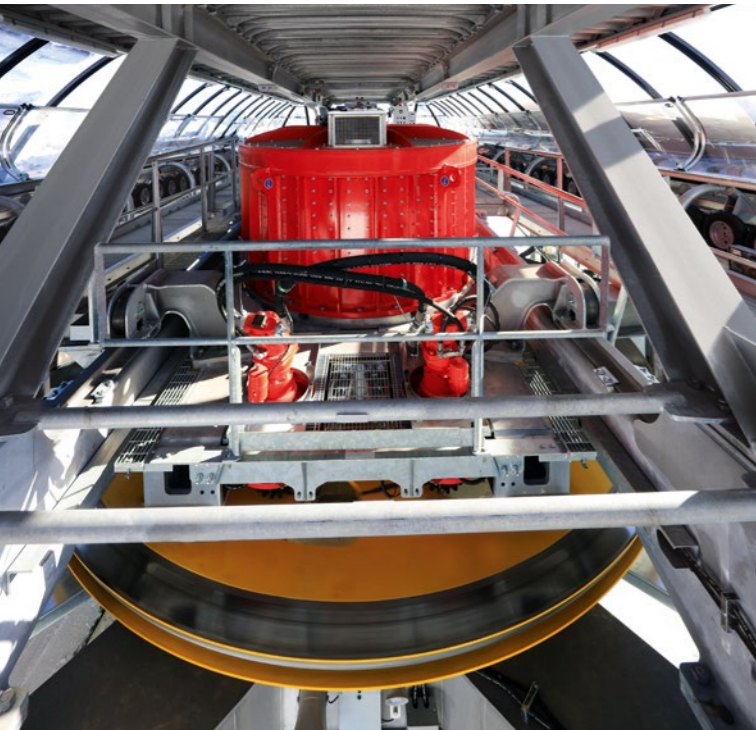



CD6C EICHENHOF II

St. Johann in Tirol / AT

Inclined length	1628 m	Power	794 kW
Vertical rise	445 m	Total number of vehicles	66
Transport capacity	2406 p/h	Total number of towers	13

The new 6-seater chairlift in the St. Johann in Tirol ski resort, from "Granderschupf" to above the former top station "Eichenhof 2" provides access to the ski resort itself and connects an area offering primarily challenging slopes for advanced skiers. The system with bubbles and seat heating transports 2,400 passengers per hour and travels a distance of 1,630 meters. This and other investments mean that

St. Johann has started the new winter season with a great deal of momentum. The leading Scandinavian ski resort operator SkiStar is especially focused on providing a holistic winter experience, in addition to maximizing the family-friendliness. The state-of-the-art technology from LEITNER ropeways has created the perfect conditions for this.

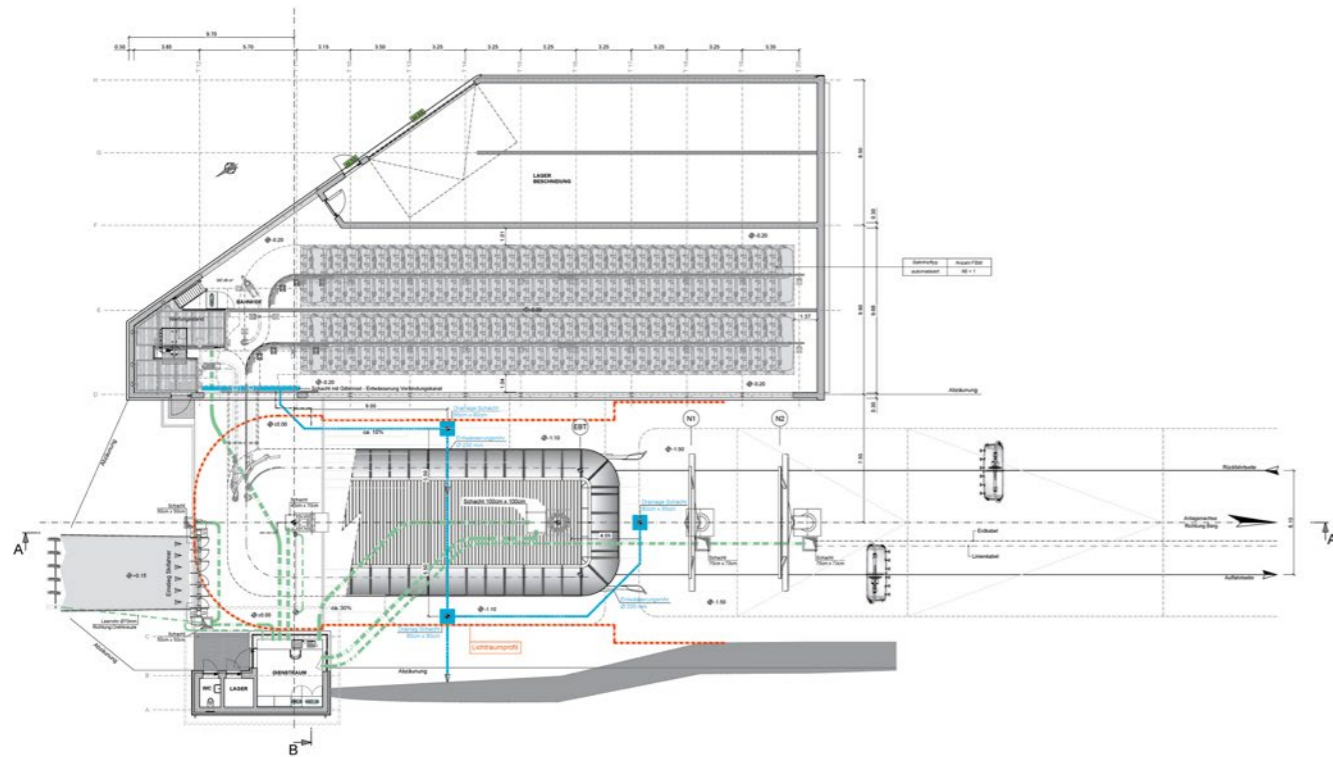





CD6C SCHNEEHÜENER-STOCK-FLYER

Andermatt / CH

Inclined length	1053 m	Power	455 kW
Vertical rise	431 m	Total number of vehicles	43
Transport capacity	2000 p/h	Total number of towers	10

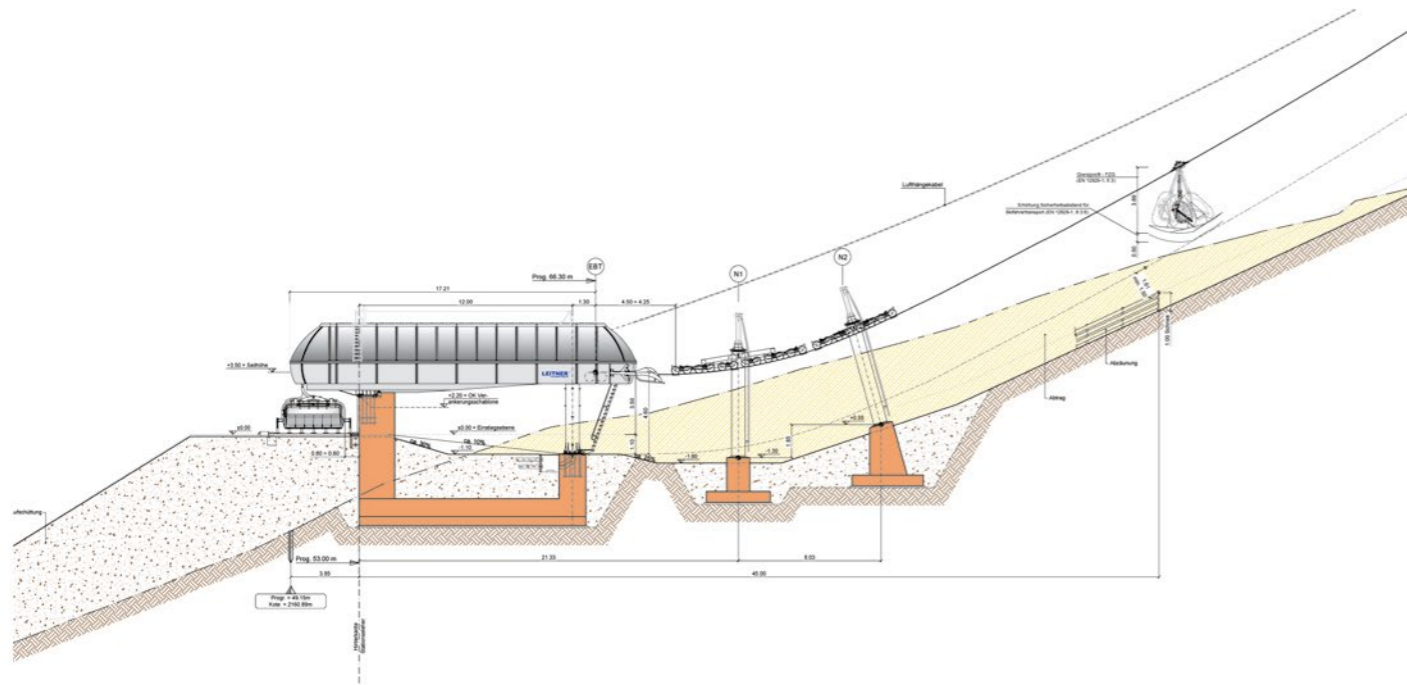



CD6C SONNE

Kronplatz - Plan de Coronas / IT

Inclined length	701 m	Power	290 kW
Vertical rise	209 m	Total number of vehicles	33
Transport capacity	2200 p/h	Total number of towers	8

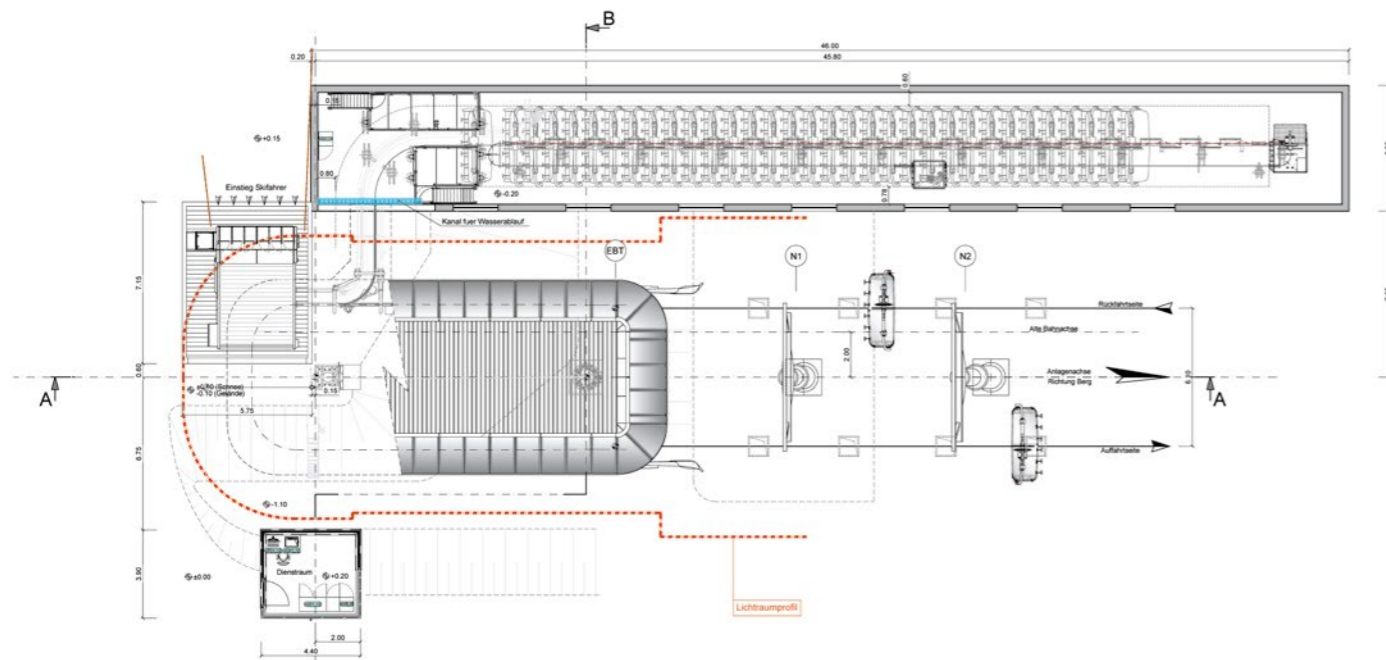





CD6 BLOK

Corvara / IT

Inclined length	926 m	Power	441 kW
Vertical rise	173 m	Total number of vehicles	54
Transport capacity	2800 p/h	Total number of towers	10

LEITNER ropeways has now been cooperating with one of the most popular Ski World Cup destinations, Alta Badia, for 71 years. Now, Grandi Funivie Alta Badia AG is writing another chapter in this success story with the new 6-seater chairlift Biok. Renovating the existing system increases the transport capacity from 2,200 to 2,800 passengers per hour.

Thanks to the innovative LEITNER DirectDrive, the installation also sets new ecological and economic standards. The Biok chairlift also boasts impressive safety and comfort. For example, the new detachable 6-seater chairlift is equipped with locking safety bars. An adjustable conveyor belt with automatic detection was also added.

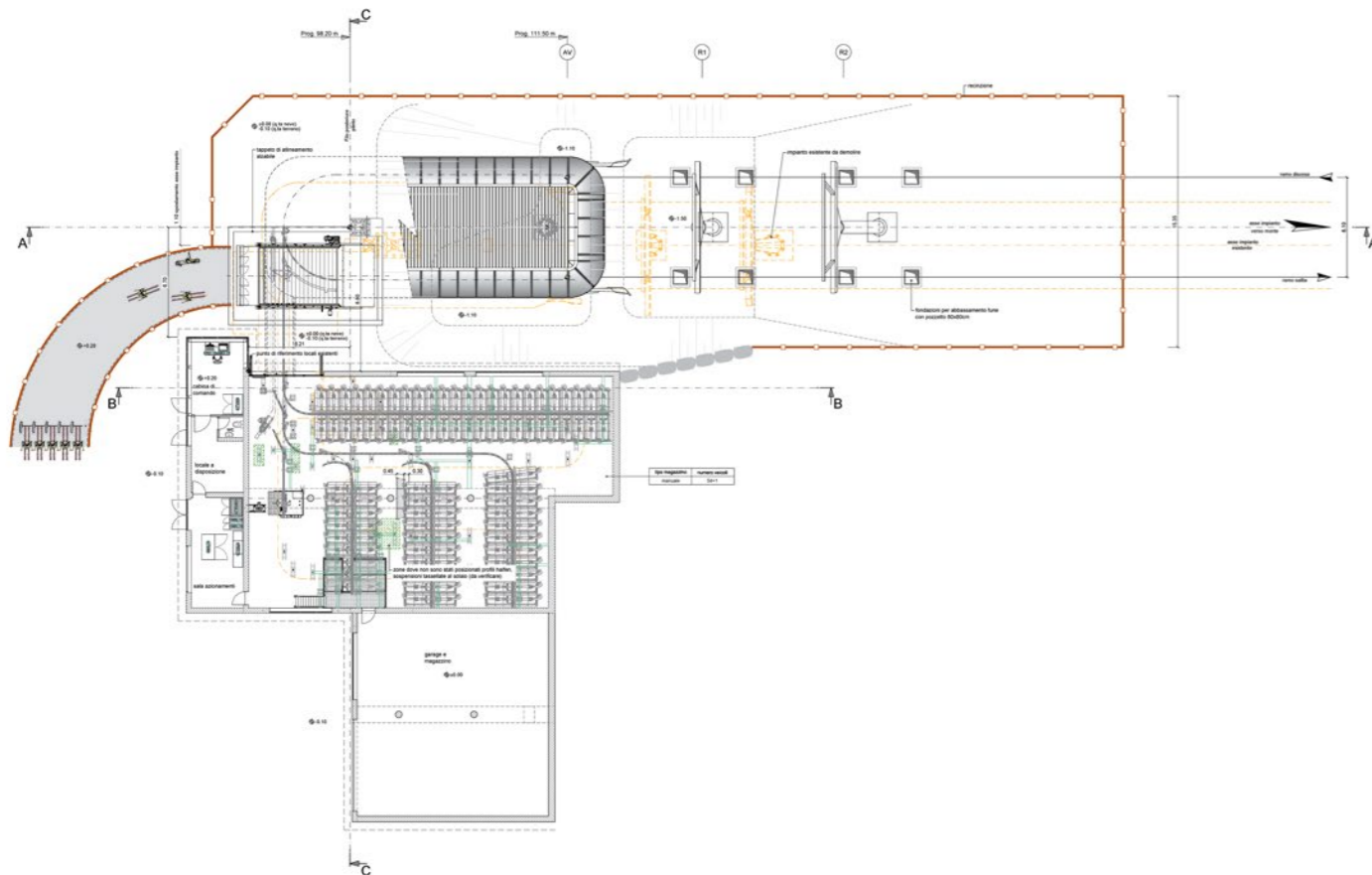





CD6C KVITFJELL

Kvitfjell / NO

Inclined length	1646 m	Power	335 kW
Vertical rise	246 m	Total number of vehicles	66
Transport capacity	2030 p/h	Total number of towers	12

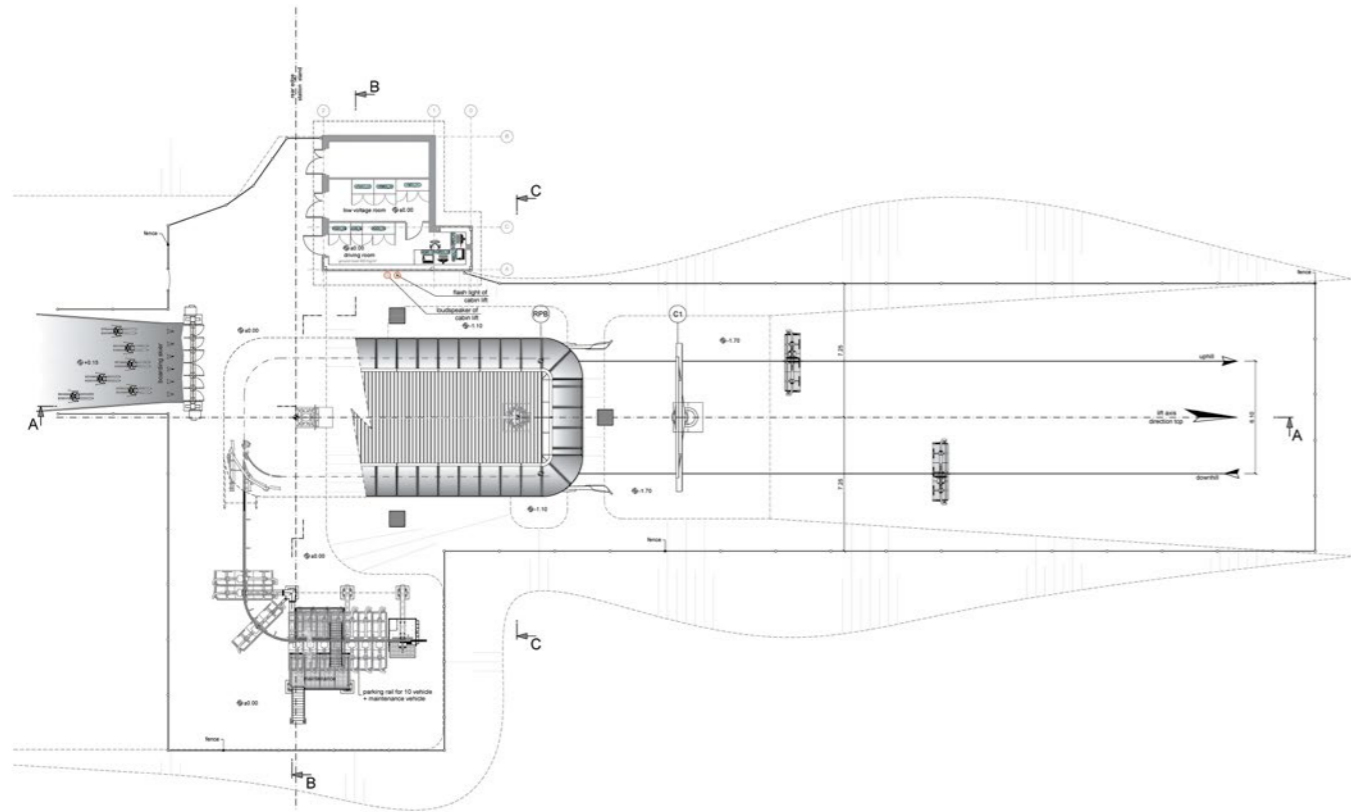





CD6C SOLISKO HALA SKRZYCZEŃSKA

Szczyrk / PL

Inclined length	1615 m	Power	662 kW
Vertical rise	349 m	Total number of vehicles	77
Transport capacity	2400 p/h	Total number of towers	11

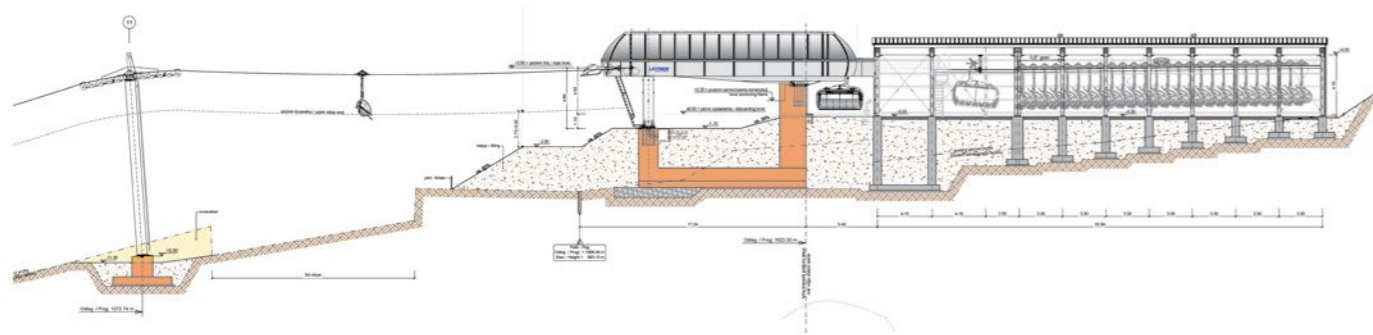





CD6C SOLISKO HALA POŚREDNIA

Szczyrk / PL

Inclined length	1386 m	Power	662 kW
Vertical rise	341 m	Total number of vehicles	83
Transport capacity	3000 p/h	Total number of towers	11

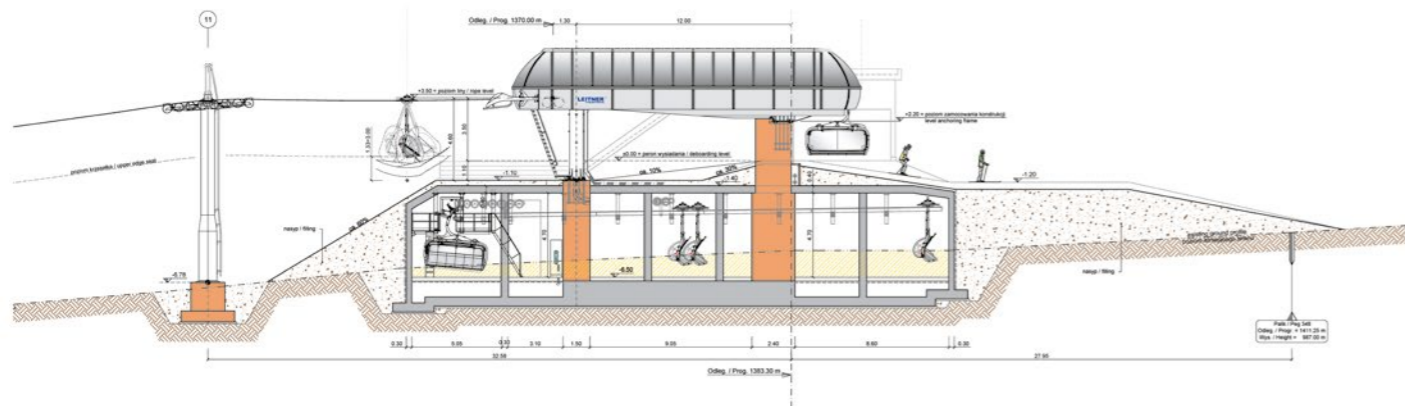



Detachable chairlifts

CD6C KOPŘIVNÁ

Mala Moravka - Koprivna / CZ

Inclined length	902 m	Power	368 kW
Vertical rise	186 m	Total number of vehicles	56
Transport capacity	3000 p/h	Total number of towers	9

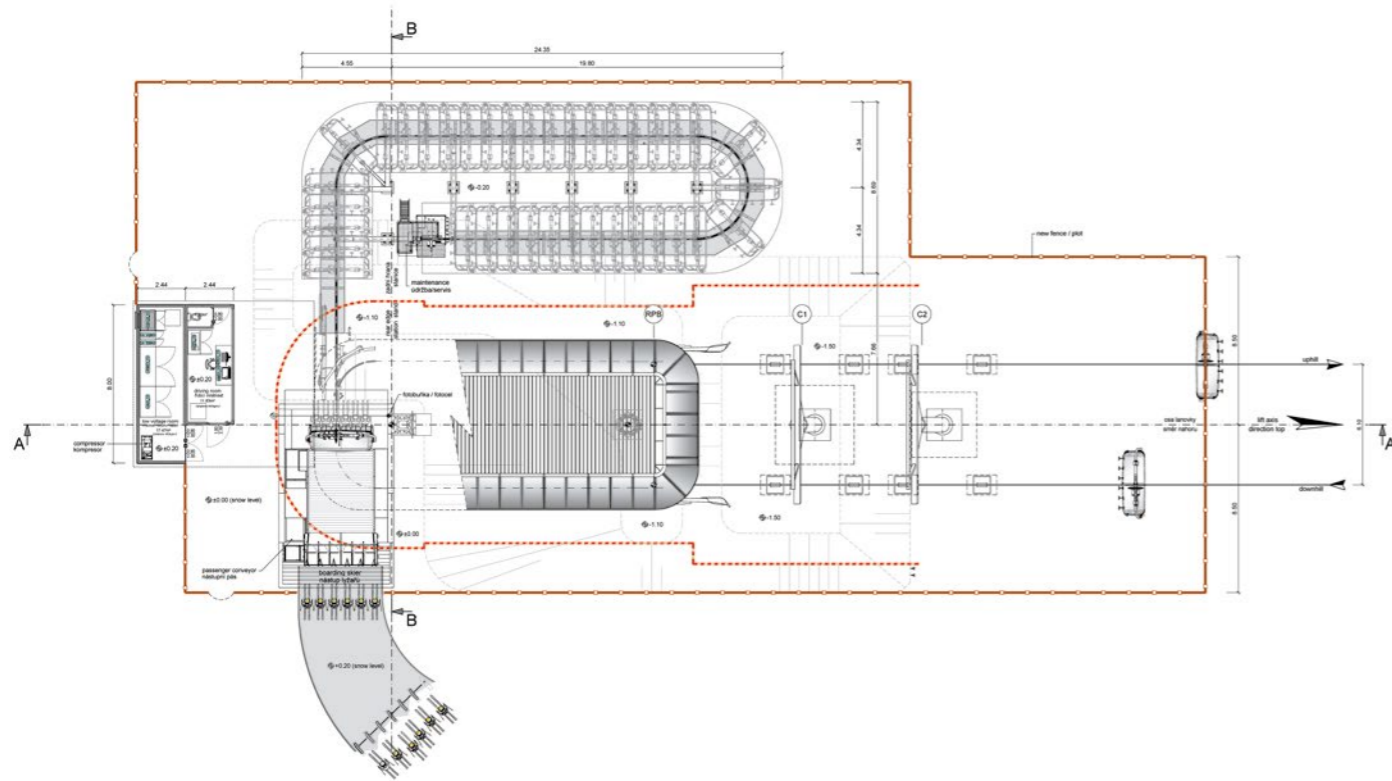



CD6 RANFOILLY EXPRESS

Les Gets / FR

Inclined length	1763 m	Power	620 kW
Vertical rise	420 m	Total number of vehicles	98
Transport capacity	3300 p/h	Total number of towers	14

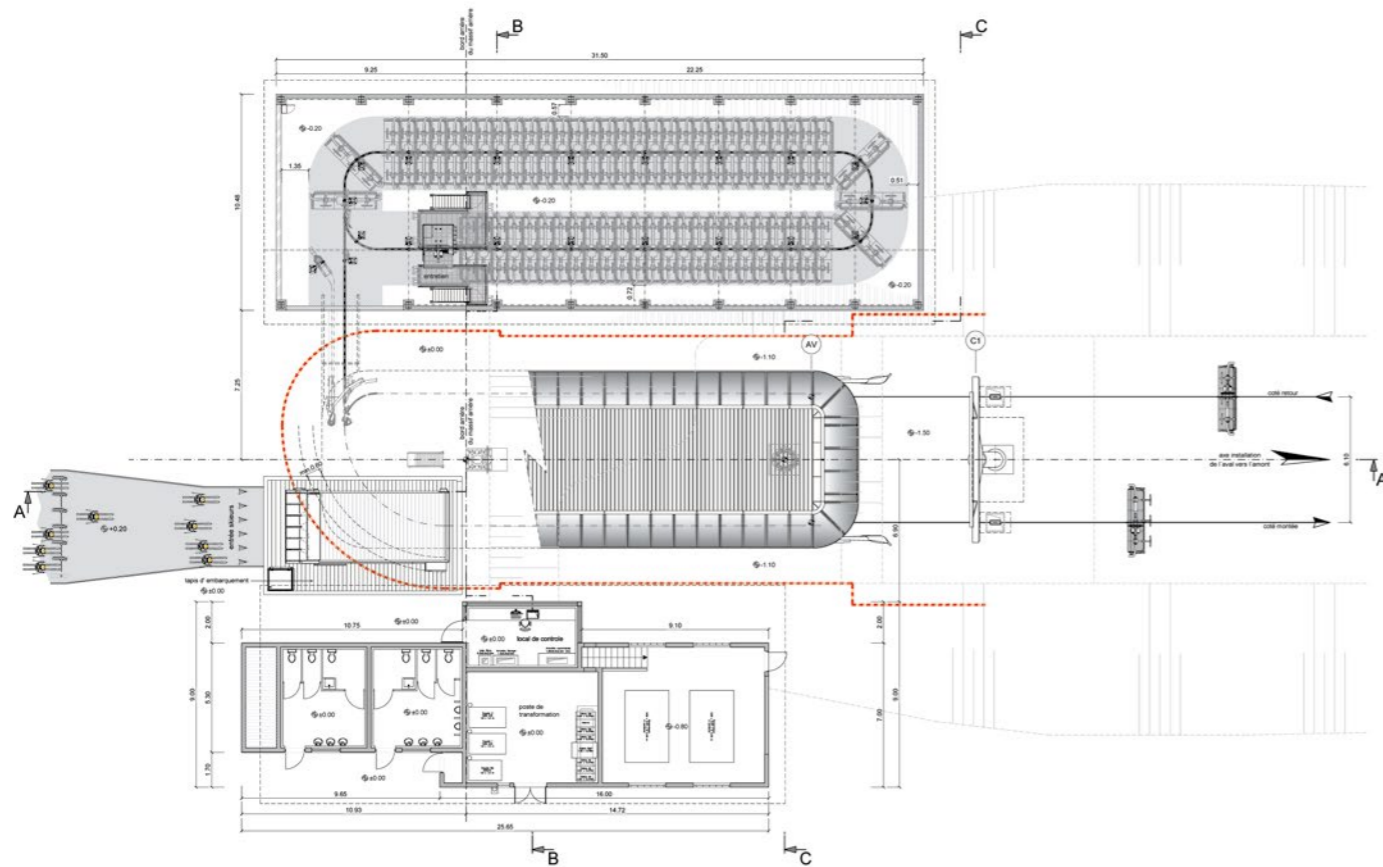





CD4C SZCZYRK JAWORZYNA

Szczyrk / PL

Inclined length	1577 m	Power	529 kW
Vertical rise	407 m	Total number of vehicles	112
Transport capacity	2400 p/h	Total number of towers	10

After construction of the top section in 2013, bottom section was built this season to replace an existing 2-seater chairlift in this ski resort. It was commissioned by operating company COS (Olympic Center Szczyrk). Its features

include the LEITNER DirectDrive, individual footrests, the CPS rope monitoring system and – like the section built in 2013 – yellow bubbles.

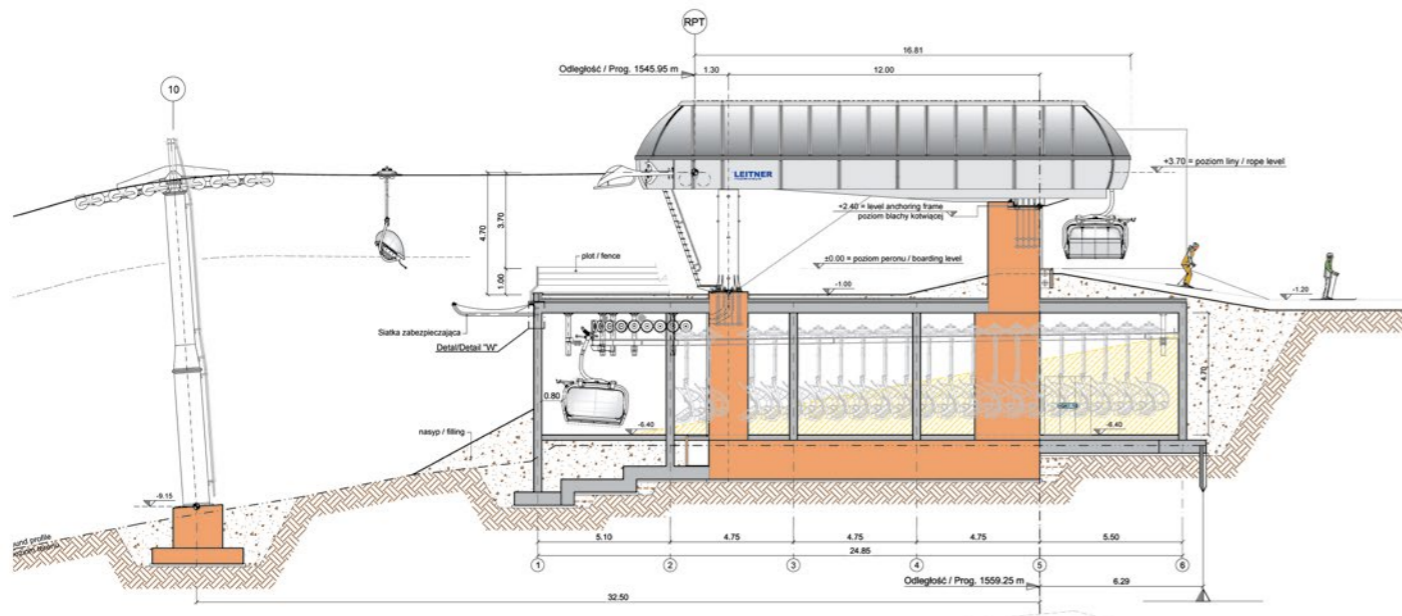





CD4C ARDAHAN

Ardahan - Merkez / TR

Inclined length	2982 m	Power	400 kW
Vertical rise	531 m	Total number of vehicles	69
Transport capacity	806 p/h	Total number of towers	15

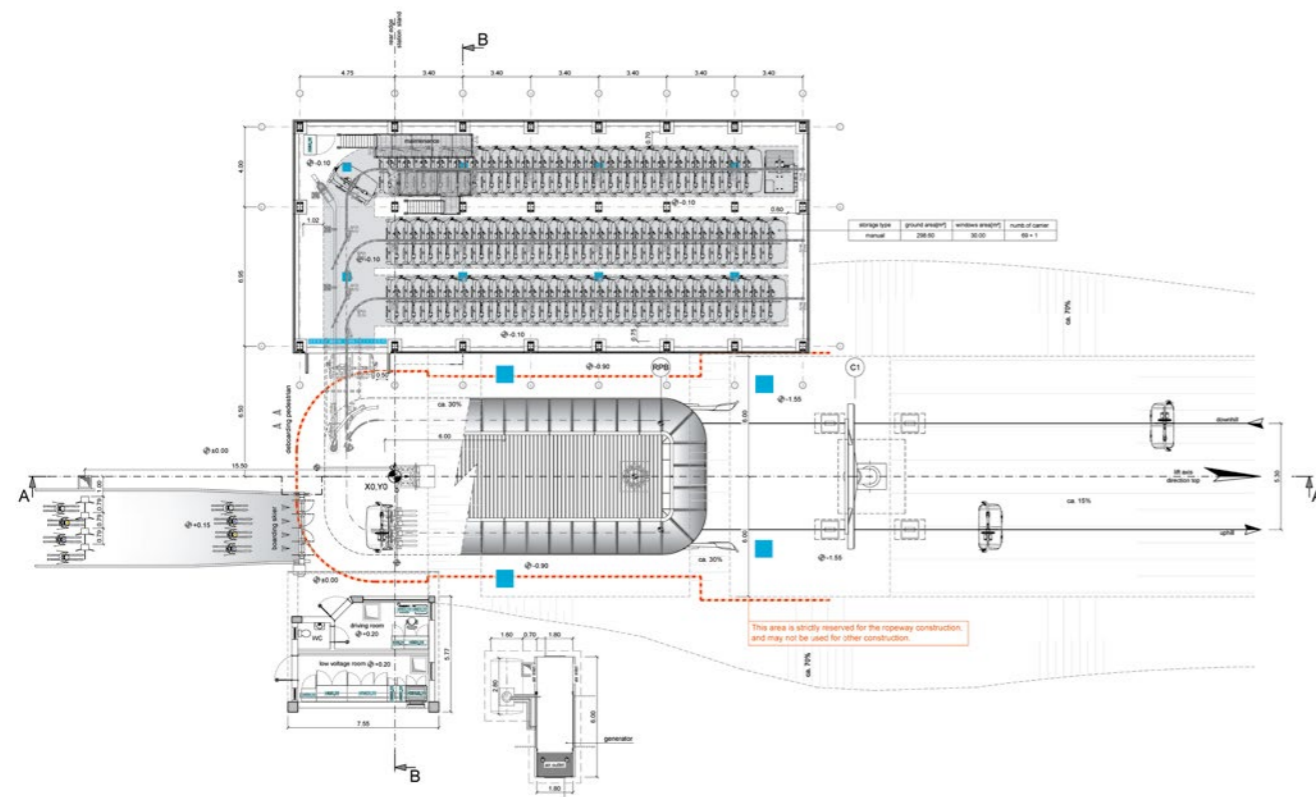



CF4 CAMPO FELICE - QUOTA

Campo Felice / IT

Inclined length	482 m	Power	80 kW
Vertical rise	68 m	Total number of vehicles	70
Transport capacity	2000 p/h	Total number of towers	5

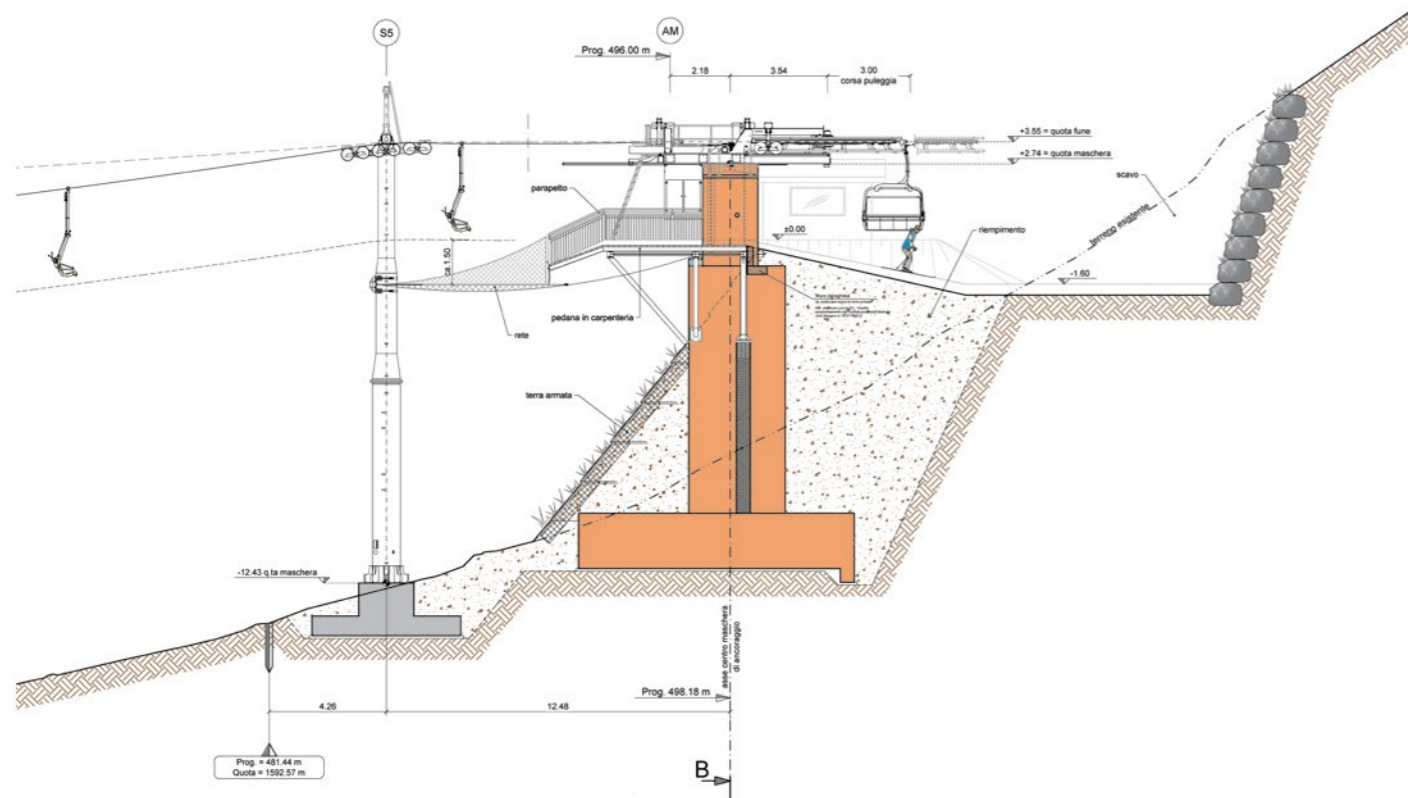



SL1 DEUTSCHNOFEN

Deutschnofen - Nova Ponente / IT

Inclined length	613 m	Power	75 kW
Vertical rise	129 m	Total number of vehicles	83
Transport capacity	720 p/h	Total number of towers	7

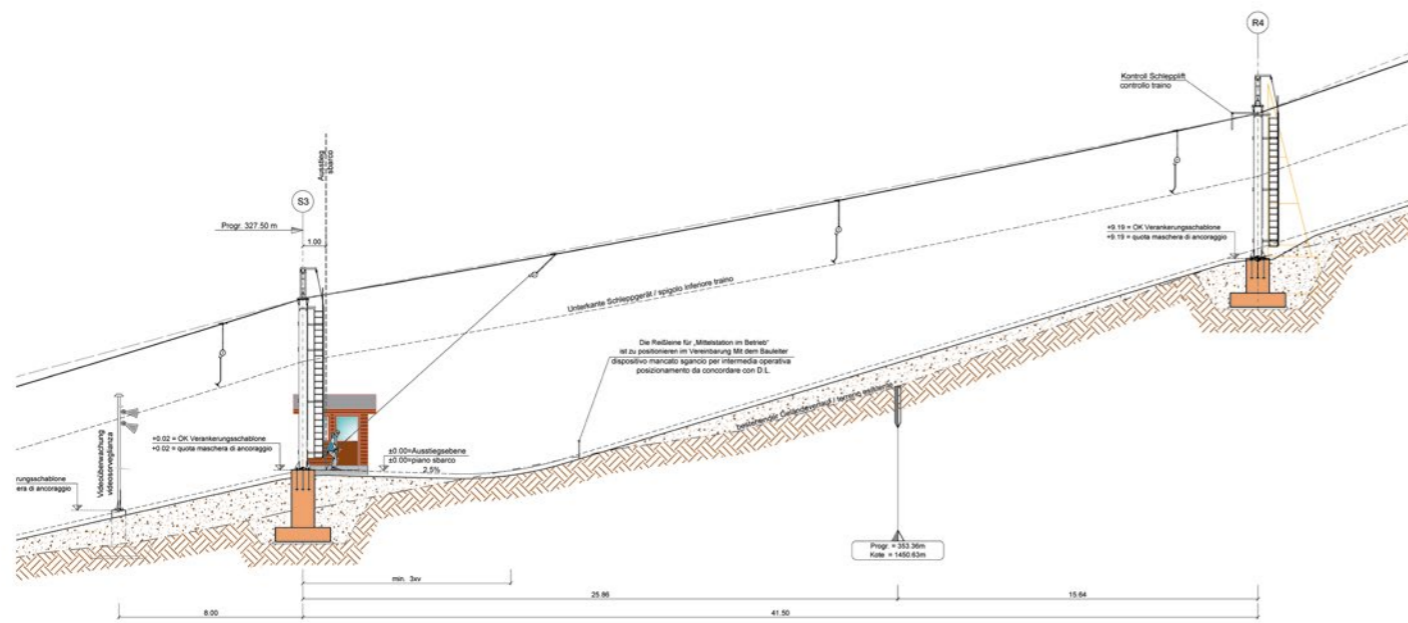



SL1 TRENKER

Toblach - Dobbiaco / IT

Inclined length	718 m	Power	90 kW
Vertical rise	186 m	Total number of vehicles	113
Transport capacity	900 p/h	Total number of towers	7

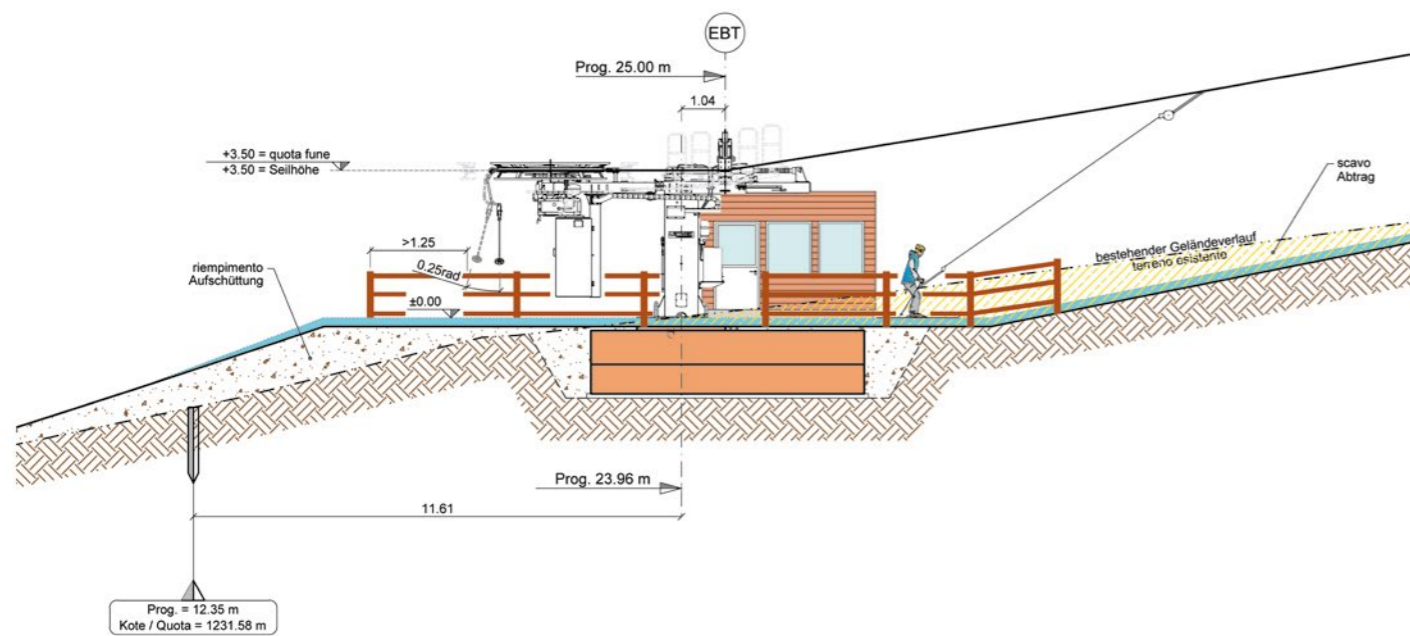

Successes 2017



Successes 2017

GD10 PIZ SETEUR I
Wolkenstein-Selva Gardena / IT

	970 m
	209 m
	3.600 p/h
	794 kW
	50
	8

GD10 GANZER X-PRESS
Neukirchen am
Großvenediger / AT

	1509 m
	402 m
	2840 p/h
	529 kW
	50
	10

GD10 SEILBAHN GÄRTEN
DER WELT
Berlin / DE

	1573 m
	85 m
	3000 p/h
	482 kW
	64
	13

GFR KVITFJELL
Kvitfjell / NO

	253 m
	2 m
	500 p/h
	100 kW
	4
	3

CD6 BLOK
Corvara / IT

	926 m
	173 m
	2800 p/h
	441 kW
	54
	10

CD6C KOPŘIVNÁ
Mala Moravka-Koprivna / CZ

	902 m
	186 m
	3000 p/h
	368 kW
	56
	9

GD10 PIZ SETEUR II
Wolkenstein-Selva Gardena / IT

	486 m
	104 m
	3.600 p/h
	353 kW
	30
	6

GD10 EICHENHOF I
St. Johann in Tirol / AT

	904 m
	140 m
	1880 p/h
	294 kW
	24
	8

GD10 PARKOVISKO HALA
SKRZYCZEŃSKA
Szczyrk / PL

	1488 m
	410 m
	3000 p/h
	794 kW
	51
	10

TMX6/8 HEMAVAN GONDOL
Hemavan / SE

	1447 m
	335 m
	2570 p/h
	441 kW
	68
	16

CD6C SONNE
Kronplatz-Plan de Corones / IT

	701 m
	209 m
	2200 p/h
	290 kW
	33
	8

CD6 RANFOILLY EXPRESS
Les Gets / FR

	1763 m
	420 m
	3300 p/h
	620 kW
	98
	14

GD10 VAUZ-PORDOI
Livinalongo del Col di Lana / IT

	2265 m
	379 m
	3.200 p/h
	882 kW
	81
	14

GD10 REISCHLBERGBAHN I+II
Hochficht / AT

	1420 m
	344 m
	2800 p/h
	926 kW
	56
	14

GD8 TORREON
Torreon / MX

	1467 m
	138 m
	750 p/h
	200 kW
	18
	6

CD8C
Kitzbühel / AT

	882 m
	300 m
	2600 p/h
	489 kW
	32
	11

CD6C EICHENHOF II
St. Johann in Tirol / AT

	1628 m
	445 m
	2406 p/h
	794 kW
	66
	13

CD6C KVITFJELL
Kvitfjell / NO

	1646 m
	246 m
	2030 p/h
	335 kW
	66
	12

GD10 SPIELJOCHBAHN I+II
Fügen / Zillertal / AT

	3887 m
	1212 m
	3000 p/h
	1660 kW
	132
	27

GD10 PALE
Pale / BA

	1233 m
	361 m
	1600 p/h
	360 kW
	23
	7

GD8 ALANYA
Alanya / TR

	847 m
	161 m
	1156 p/h
	162 kW
	17
	5

CD8C SPITZBAHN
Obertauern / AT

	1482 m
	397 m
	2585 p/h
	794 kW
	48
	17

CD6C SCHNEEHÜENER-
STOCK-FLYER
Andermatt / CH

	1053 m
	431 m
	2000 p/h
	455 kW
	43
	10

CD6C SOLISKO HALA
SKRZYCZEŃSKA
Szczyrk / PL

	1615 m
	349 m
	2400 p/h
	662 kW
	77
	11

CD6C SOLISKO HALA
POŚREDNIA
Szczyrk / PL



	1386 m
	341 m
	3000 p/h
	662 kW
	83
	11

CF2 CAMPOROTONDO -
MONTE CESA
Camporotondo / IT



	649 m
	200 m
	1198 p/h
	100 kW
	92
	7

CD4C SZCZYRK JAWORZYNA
Szczyrk / PL



	1577 m
	407 m
	2400 p/h
	529 kW
	112
	10

SL2 SCHMIEDEFELD
Schmiedefeld / DE



	884 m
	139 m
	986 p/h
	75 kW
	98
	8

CD4C ARDAHAN
Ardahan-Merkez / TR



	2982 m
	531 m
	806 p/h
	400 kW
	69
	15

SL1 DEUTSCHNOFEN
Deutschnofen-Nova Ponente / IT



	613 m
	129 m
	720 p/h
	75 kW
	83
	7

CF4 CAMPO FELICE - QUOTA
Campo Felice / IT



	482 m
	68 m
	2000 p/h
	80 kW
	70
	5

SL1 TRENKER
Toblach-Dobbiaco / IT



	718 m
	186 m
	900 p/h
	90 kW
	113
	7

	Inclined length
	Vertical rise
	Transport capacity
	Power
	Total number of vehicles
	Total number of towers

	Winter Sports
	Urban
	Tourism
	Material

LEITNER ropeways



Sterzing (Italy)



Sterzing (Italy)



Telfs (Austria)



Montmélian (France)



Grand Junction (USA)



Stará L'ubovňa (Slovakia)



